

Switches & Control Gear

Toggle Switch

Detailed product specifications are available on: us.100y.com.tw

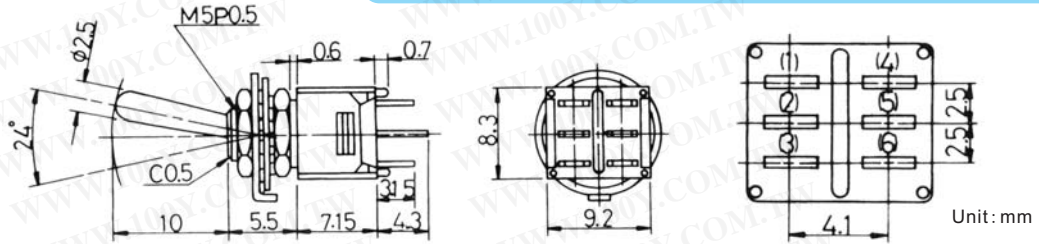

Part No.	Product No.	Description	No. of Pos.	Volt./Current	Type
5675	6316	Toggle Switch	6P2	3A/125Vac	ON-ON



Contact R: 50m Ω Max.
 Insulation R: DC500V 100M Ω Min
 Dielectric strength: AC 1000V 1 minute
 Electrical life: 20,000 make-and-break cycles at full load

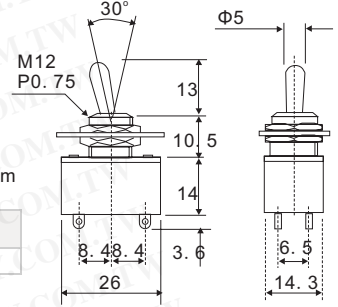

Part No.	Product No.	Description	No. of Pos.	Volt./Current?	Type
12079	6318-4P2	Toggle Switch	4P2	2A-250V 4A-125V	ON-OFF



Rating: AC 125V 15A 250V 10A
 Contact R: 50m Ω Max.
 Insulation R.: DC500V 100M Ω Min.
 Dielectric Strength : AC 1000V 1 minute.
 Operating Temperature : -20°C~+65°C
 Electrical Life : 50,000 make-and-break cycles at full load.

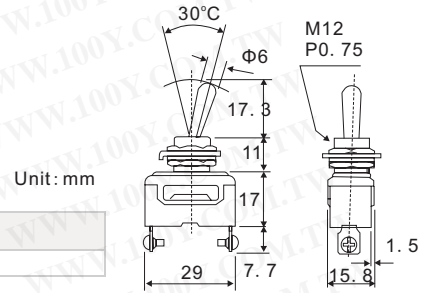

Part No.	Product No.	Description	No. of Pos.	Volt./Current	Type
8399	6323N-2P2	Toggle Switch(ROHS)	2P2	15A/125Vac	ON-OFF



Rating: AC 125V 15A 250V 10A
 Contact R.: 50m Ω Max.
 Insulation R.: DC500V 100M Ω Min.
 Dielectric Strength : AC 1000V 1 minute.
 Operating Temperature : -20°C~+65°C
 Electrical Life : 50,000 make-and-break cycles at full load.

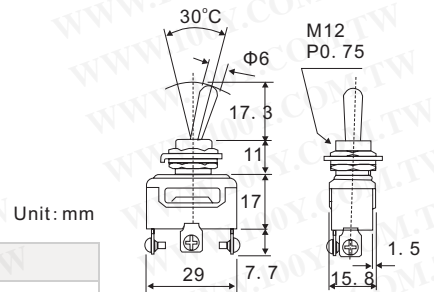

Part No.	Product No.	Description	No. of Pos.	Volt./Current	Type
7741	6324N-3P2	Toggle Switch	3P2	10A/250Vac	ON-ON



Rating: AC 125V 15A 250V 10A
 Contact R.: 50m Ω Max.
 Insulation R.: DC500V 100M Ω Min.
 Dielectric Strength : AC 1000V 1 minute.
 Operating Temperature : -20°C~+65°C
 Electrical Life : 50,000 make-and-break cycles at full load.

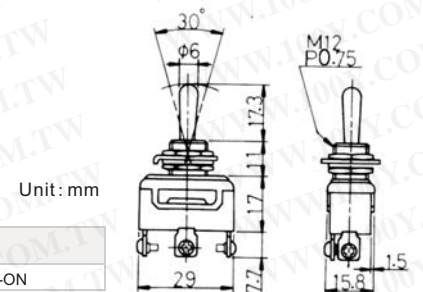

Part No.	Product No.	Description	No. of Pos.	Volt./Current	Type
8398	6325N-3P3	Toggle Switch	3P3	15A/125V	ON-OFF-ON

- We provide a wide range of products to development and maintenance engineers in all type of business
- If you cannot find the components you want on the catalogue, please call us.

Taiwan: 886-3-5753170
 Shanghai: 021-54151736 Shenzhen: 0755-83298787

Centenary Materials
 Waiting for your phone call



T E L : Taiwan: 886-3-5753170
 F A X : Taiwan: 886-3-5753172
 E-mail: Taiwan: us_sale@100y.com.tw

Shenzhen: 86-755-83298787
 Shenzhen: 86-755-83640655
 Shenzhen: 100y@163.com

Shanghai: 86-21-54151736
 Shanghai: 86-21-64605107
 Shanghai: 100y-1@163.com