

Switches & Control Gear

Panel Mounting

Detailed product specifications are available on: us.100y.com.tw



Part No.	Product No.	Description	Pins/Terminal Type	Contact Function	Contact Rating	Button/Body Color
3464	6501A	Panel Mounting Button Switches	2	A OFF-(ON)	1A 125V AC	Red

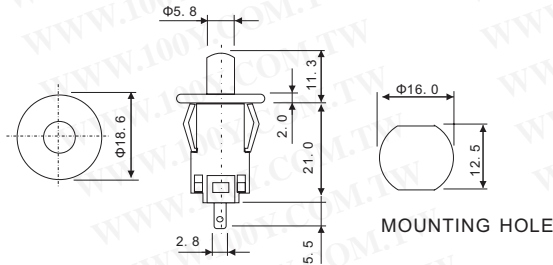

SPECIFICATIONS

- Rating: 0.3A 25VAC, 0.15A 250VAC
- Circuit : OFF-(ON)
- Insulated voltage: DC500V100MΩ OR MORE
- Withstand voltage: AC 1500V FOR Imin.
- Contact resistance: DC2-4V 100MΩ OR LESS

Part No.	Product No.	Description	Pins/Terminal Type	Contact Function	Button/Body Color
10653	6513	Momentary Switches	2	A Momentary OFF-(ON)	White

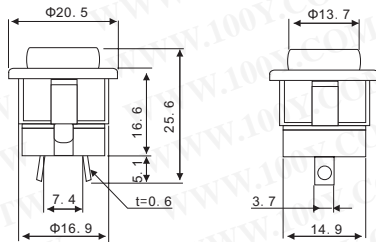

SPECIFICATIONS

- Circuit : OFF-(ON)
- Rating: 3A 125VAC.
- Contact resistance: DC500V100MΩ OHMS.
- Insulation resistance: AC 1000V FOR Imin.
- Dielectric strength: 20m Mar.

Part No.	Product No.	Description	Pins/Terminal Type	Contact Function	Contact Rating	Button/Body Color
6721	6516	Push-Button	2P/Soldering	B. OFF-(ON)	3A/125VAC	RED

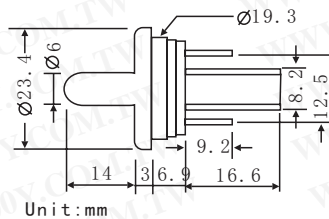

Key Specifications

- Model: 6517 (Push OFF)
- Tamper switch
- Size: 40.6*23.4*12.5

Part No.	Product No.	Description	Pins/Terminal Type	Contact Function	Button/Body Color
12055	6517	Momentary Switches	2	A OFF-(ON)	White

Miniature, Sub-Miniature Panel Mounting

Detailed product specifications are available on: us.100y.com.tw



Contact material:	Silver metal
Contact capacity:	250 VAC/5A (p. f. ≥0.9)
Electric resistance:	<50mΩ
Electrical life	5A/250VAC 50,000 6A/250VAC 60,000 2A/250VAC 200,000 1A/250VAC 400,000

Insulated resistance:	<500VDC. >10 ¹¹ MΩ
Solder resist temp:	600°C/5 seconds
Operating temp:	-25°C TO +55°C
Storage temp:	-40°C TO +85°C
Shell material:	Resist temperature&soil, high capability, plastic materials, fire-proof

Part No.	Product No.	Manufacturer	Description	Button/Body Color	Contact Rating	Pins/Terminal Type
50010	01P-RM40.Q1P+G	META	Rectangular Momentary Button Switches	16mm	1A1B	250VAC/5A



- Front size: 9 x 9 mm
- Front protection: IP 40
- Mounting hole size: 8 mm dia.
- Terminals: Plug-in terminal | Soldering terminal
- Illumination: LED
- Front shape: Square
- Switch rating: 50 VAC, 800 mA
- Switching system: Snap-action switching element
- Mounting style: raised mounting | PCB mounting
- Contacts: 1 Normally open
- Switching action: Momentary action
- Contact material: Silver

Part No.	Product No.	Manufacturer	Description	Button/Body Color	Contact Rating	Pins/Terminal Type	Contact Function
48370	19-159.015+5+F36	EAO	Low-level Illuminated Pushbutton Switch	Green	50 VAC, 800 mA	4	1 Normally open



T E L : Taiwan: 886-3-5753170
F A X : Taiwan: 886-3-5753172
E-mail : Taiwan: us_sale@100y.com.tw

Shenzhen: 86-755-83298787
Shenzhen: 86-755-83640655
Shenzhen: 100y@163.com

Shanghai: 86-21-54151736
Shanghai: 86-21-64605107
Shanghai: 100y-1@163.com