

Switches & Control Gear

Miniature PCB- Keypswitches

Detailed product specifications are available on: us.100y.com.tw

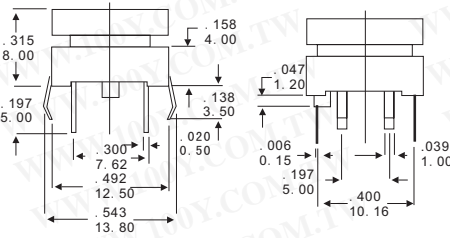
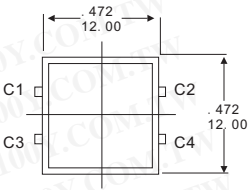

SPECIFICATIONS

Contact arrange	S.P.S.T
Humidity	85%RH max.
Contact resistance	100mΩ max. initial
Insulated resistance	100MΩ max.
Endure voltage strength	250VAC, 1 minl
Operating temperature:	10°C to 60°C
Operating ability:	250gf max.
Life:	300,000 cycles min.
error endurance :	10 to 55 Hz 0.75mm double amplitude during 2 hrs
Total circle:	0.3mm ± 0.1mm
LED grade:	50mA / 12VDC Voltage 6V max. current 20mA max.

Part No.	Product No.	Description	Pins	Type	Contact Rating
18102	YLP12-GC02	illuminated Tact Switches	6P	12*12mm	12Vdc/50mA
18104	YLP12-RC02	illuminated Tact Switches	6P	12*12mm	12Vdc/50mA
18103	YLP12-YC02	illuminated Tact Switches	6P	12*12mm	12Vdc/50mA



YLP13-A-5-A-532



YLP13-A-5



YLP13-B-5

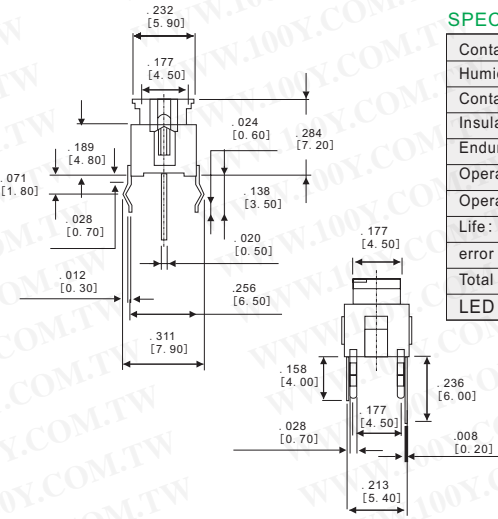

SPECIFICATIONS

Contact arrange	S.P.S.T
Humidity	85%RH max.
Contact resistance	100mΩ max. initial
Insulated resistance	100MΩ max.
Endure voltage strength	250VAC, 1 minl
Operating temperature:	10°C to 60°C
Operating ability:	250gf max.
Life:	300,000 cycles min.
error endurance :	10 to 55 Hz 0.75mm double amplitude during 2 hrs
Total circle:	0.3mm ± 0.1mm
LED grade:	50mA / 12VDC Voltage 6V max. current 20mA max.

Part No.	Product No.	Description	Pins	Type	Contact Rating
18094	YLP13-A-5-A-532	illuminated Tact Switches	4P	10*10mm	12Vdc/50mA
18095	YLP13-A-5-B1-132	illuminated Tact Switches	6P	10*10mm	12Vdc/50mA
18096	YLP13-A-5-B2-232	illuminated Tact Switches	6P	10*10mm	12Vdc/50mA
18097	YLP13-A-5-B3-332	illuminated Tact Switches	6P	10*10mm	12Vdc/50mA
18098	YLP13-B-5-C-532	illuminated Tact Switches	4P	10*10mm	12Vdc/50mA
18100	YLP13-B-5-D1-132	illuminated Tact Switches	6P	10*10mm	12Vdc/50mA
18099	YLP13-B-5-D2-232	illuminated Tact Switches	6P	10*10mm	12Vdc/50mA
18101	YLP13-B-5-D3-332	illuminated Tact Switches	6P	10*10mm	12Vdc/50mA

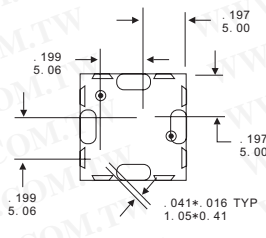
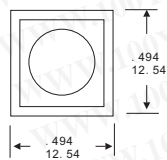
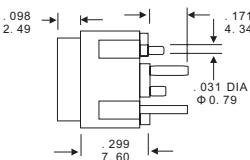

SPECIFICATIONS

- Contact rating : 250Ma max. @ 50V AC or DC max.
- Mechanical life: 50, 000 actuations.
- Contact resistance: 20 milliohms max.
- Insulated resistance: 100 milliohms max.
- Dielectric strength: 1, 000V RMS min. @ sea level.
- Operating temperature: -30°C TO 65°C

MATERIALS

- CASE : Class filled nylon
- ACTUATOR : ABS
- Moveable contact: Beryllium copper, silver plated
- Housing: Stainless steel
- Stationary contacts & terminal: Copper alloy, silver plated

Part No.	Product No.	Description	Pins	Type	Contact Rating	Button Color
7911	YR18-801-1C05	DIP Pushbutton Switches	2	OFF-MOM	25mA msx. @50V AC or DC max.	
10613	YR18-801-2	DIP Pushbutton Switches 2P	2	OFF-MOM	25mA msx. @50V AC or DC max.	
7913	YR18-801-3C05	DIP Pushbutton Switches	2	OFF-MOM	25mA msx. @50V AC or DC max.	
7912	YR18-801-5C05	DIP Pushbutton Switches	2	OFF-MOM	25mA msx. @50V AC or DC max.	
2198	YR18-801-6	DIP Pushbutton Switches	2	OFF-MOM	25mA msx. @50V AC or DC max.	
8539	YR18-801-7C05	DIP Pushbutton Switches	2Pins	OFF-MOM	25mA msx. @50V AC or DC max.	
37540	YR18-801-9C05	DIP Pushbutton Switches	2Pins	OFF-MOM	25mA msx. @50V AC or DC max.	Gray



T E L : Taiwan: 886-3-5753170
 F A X : Taiwan: 886-3-5753172
 E-mail : Taiwan: us_sale@100y.com.tw

Shenzhen: 86-755-83298787
 Shenzhen: 86-755-83640655
 Shenzhen: 100y@163.com

Shanghai: 86-21-54151736
 Shanghai: 86-21-64605107
 Shanghai: 100y-1@163.com