

Inductors & Filters

Chassis Mounting Filters

Detailed product specifications are available on: us.100y.com.tw



FN2060-16-06

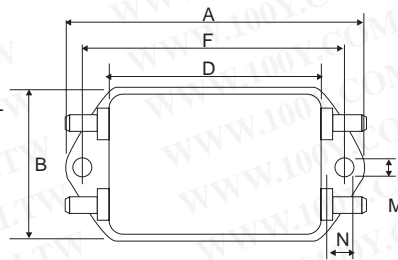
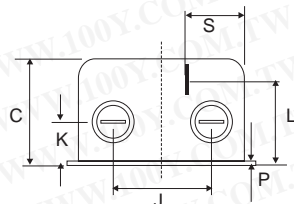

A	85
B	54
C	40.3
D	64.8
F	75
J	27
K	12.3/8.3 ^φ
L	29.8
M	5.3
N	6.3
P	0.7
S	11.4/34.9 ^φ

Part No.	Product No.	Manufacturer	Description	Rated Vol.	Current (Amp)
49739	FN2060-16-06	Schaffner	Multi-stage general purpose EMI filter	250Vac	16A



FN2060-20-06

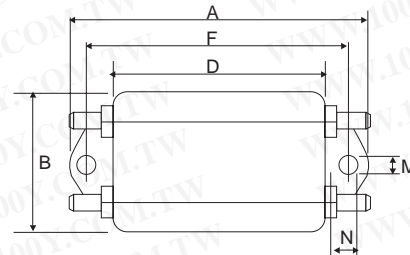
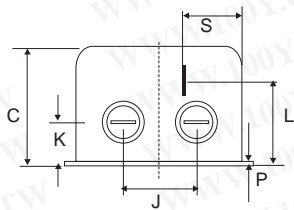

A	113.5
B	57.5
C	45.4±1.2
D	94
F	103
J	25
K	12.4
L	32.4
M	4.4
N	6
P	0.9
S	15.5

Part No.	Product No.	Manufacturer	Description	Rated Vol.	Current (Amp)
49742	FN2060-20-06	Schaffner	Multi-stage general purpose EMI filter	250Vac	20A



YK10T1

Part No.	Product No.	Manufacturer	Description	Rated Vol.	Current (Amp)
48805	YK10T1	YUNPEN	AC Series EMI Power Line Filter	125/250V	10A

FEATURES:

- The ZCB-11 and ZCB-M series EMC filters exhibit outstanding attenuation characteristics with respect to both differential mode and common mode noise components in the MF and HF bands.
- Leakage current is maintained at less than 0.5mA for the ZCB-M series and less than 0.75mA for the ZCB-11 series.
- Efficient manufacturing makes these filters highly cost-effective.
- Connection terminals employing Faston® #110 facilitate implementation and maintenance.
- It is a product conforming to RoHS directive.



ZCB2206-11

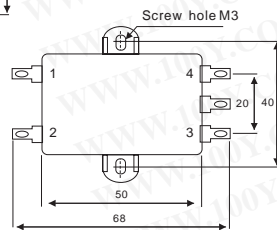
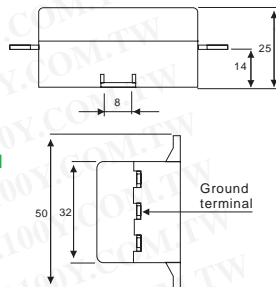

Part No.	Product No.	Manufacturer	Description	Rated Vol.	Current (Amp)
40040	ZCB2206-11	TDK	EMC Filter for AC Power Line	250V	6A

FEATURES:

- The ZRGT-M series EMC filters are highly effective at preventing both the radiation and penetration of EMC noise. The parts are, therefore, highly immune to externally generated noise and do not, themselves, serve as sources of radiated noise.



- For the CISPR frequency band, this product provides superior attenuation for both differential mode and common mode noise components
- Withstand voltage is AC.1250V between the lines and AC.2000V between line and ground
- Single-direction block terminal design simplifies wiring requirement, thereby improving workflow

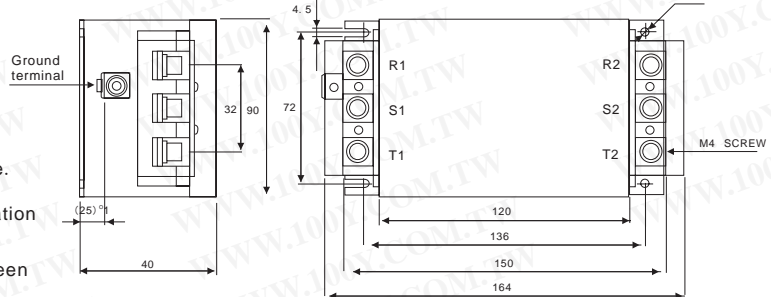

T E L : Taiwan: 886-3-5753170
 F A X : Taiwan: 886-3-5753172
 E-mail : Taiwan: us_sale@100y.com.tw

Shenzhen: 86-755-83298787
 Shenzhen: 86-755-83640655
 Shenzhen: 100y@163.com

Shanghai: 86-21-54151736
 Shanghai: 86-21-64605107
 Shanghai: 100y-1@163.com