

Inductors & Filters

IEC Inlet Filters

Detailed product specifications are available on: us.100y.com.tw

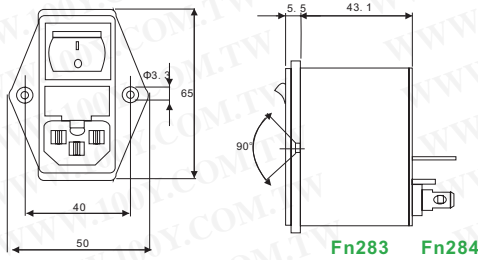

Part No.	Product No.	Manufacturer	Description	Current (Amp)	Vol.
49728	FN283-2-06	Schaffner	Compact filtered power entry module(Inlet+Switch+1 Fuse)	2A	250Vac
49729	FN283-4-06	Schaffner	Compact filtered power entry module(Inlet+Switch+1 Fuse)	4A	250Vac
49730	FN283-6-06	Schaffner	Compact filtered power entry module(Inlet+Switch+1 Fuse)	6A	250Vac
49735	FN284-2-06	Schaffner	Compact filtered power entry module(Inlet+Switch+2 Fuses)	2A	250Vac
49736	FN284-4-06	Schaffner	Compact filtered power entry module(Inlet+Switch+2 Fuses)	4A	250Vac
49737	FN284-6-06	Schaffner	Compact filtered power entry module(Inlet+Switch+2 Fuses)	6A	250Vac

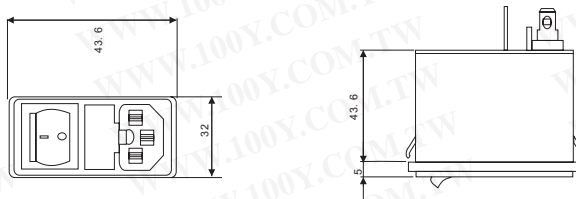

Part No.	Product No.	Manufacturer	Description	Current (Amp)	Vol.
50255	FN286-6-06	Schaffner	Compact filtered power entry module(Inlet+Switch+2 Fuses)	6A	250Vac



SPECIFICATION

Max continal working temperature	250VAC, 50/60Hz
Working frequency	DC-400Hz
Rating current	1-10A (Max 40°C)
Gas crack	>3mm, according EN60601-1
Defend grade	IP40, According IEC60529
Temperature range (working or storage)	-25°C~+85°C (25/85/21)

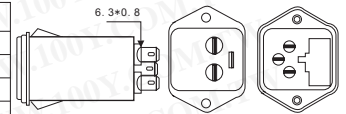

FN 9260S/FN 261

Part No.	Product No.	Manufacturer	Description	Current (Amp)	Vol.
49723	FN9260-10-06	Schaffner	General purpose power entry module with fuses(Inlet+2 Fuses)	10A	250Vac
49718	FN9260-2-06	Schaffner	General purpose power entry module with fuses(Inlet+2 Fuses)	2A	250Vac
49721	FN9260-4-06	Schaffner	General purpose power entry module with fuses(Inlet+2 Fuses)	4A	250Vac
49722	FN9260-6-06	Schaffner	General purpose power entry module with fuses(Inlet+2 Fuses)	6A	250Vac



Part No.	Product No.	Description	Current (Amp)	Vol.
28167	PS0SXDS3A	FILTERS	3A	120V/1250V

Chassis Mounting Filters

Detailed product specifications are available on: us.100y.com.tw



Characters

- Maximum leakage current line-to-ground
 - @ 115VAC 60Hz: 0.25mA
 - 1.0mA (100000pF)
 - @ 250VAC 50Hz: 0.45mA
 - 2.0mA (100000pF)
- DIELECTRIC STRENGTH (One minute)
 - line-to-ground:2250VDC
 - DCline-to-line:1450VDC

- Operating frequency: 50/60Hz
- Rating voltage: 115/250VAC

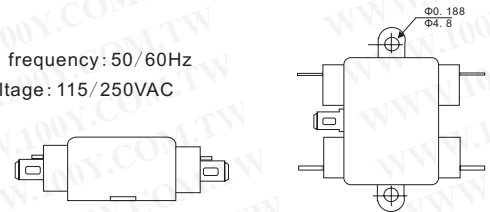

Part No.	Product No.	Manufacturer	Description	Rated Vol.	Current (Amp)
48806	10DBAG5-STD	DELTA	AC Series EMI Power Line Filter	115/250VAC	10A

