

# Speakers & Microphones

## Round Alnico Type Speakers

Detailed product specifications are available on: [us.100y.com.tw](http://us.100y.com.tw)

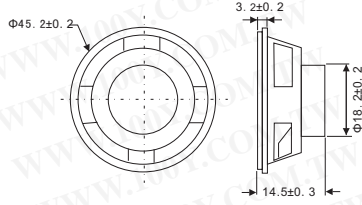

Article No :	45CP08H
Rated impedance (Ω)	8
Rated power (W)	2.0
max power (W)	4.0
Resonant frequency (Hz)	370±74
Frequency range (Hz)	250~20k
Sound pressure level (dB)	85±3
Materials:	Metal

Part No.	Product No.	Manufacturer	Description	Dia.*Depth	Impedance Ω±15%	Nini-Watts Nor.(mW)	Nini-Watts Max.(mW)	Frequency Range(Hz)
18349	45CP08H	FCE	Round Alnico Type Speakers 8Ω 2.0W	Φ45.2x14.5H mm	8	2.0W	4.0W	250~20K

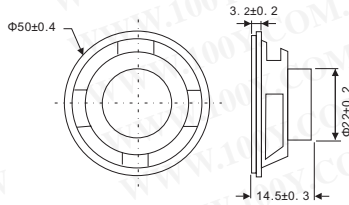

Article No :	50CP08H
Rated impedance (Ω)	8
Rated power (W)	1.0
max power (W)	2.0
Resonant frequency (Hz)	210±50
Frequency range (Hz)	150~20k
Sound pressure level (dB)	84±3
Materials:	Metal

Part No.	Product No.	Manufacturer	Description	Dia.*Depth	Impedance Ω±15%	Nini-Watts Nor.(mW)	Nini-Watts Max.(mW)	Frequency Range(Hz)
18350	50CP08H	FCE	Round Alnico Type Speakers 8Ω 1.0W	Φ50x18.4H mm	8	1.0W	2.0W	150~20K



Model	Dimension Dia. x Depth	Impedance +/- 15%	Power Rating Mini-Watts		Fo Lowest Resonant Frequency +/- 20%	SPL Normal Power Input/ 0.5 meter db	Frequency Range SPL-10 db Hz.	Material of Diaphragm	Material of Frame	Type Out-looking
			Normal	Max.						
57CP08	57x9.7	8	300	500	390	85	200~3000	Paper	Metal Frame	Round
57CP08H-2	57X11.8	8	1000	1500	450	92	250~4500	Paper	Metal Frame	Round

Part No.	Product No.	Manufacturer	Description	Dia.*Depth	Impedance Ω±15%	Nini-Watts Nor.(mW)	Nini-Watts Max.(mW)	Frequency Range(Hz)
21741	57CP08	Veco	Round Alnico Type Speakers 8Ω 0.3W	Φ57x9.7H mm	8	300mW	500mW	200~3000
18351	57CP08H	FCE	Round Alnico Type Speakers 8Ω 2.0W	Φ57x20H mm	8	2.0W	4.0W	130~20K
21740	57CS08F	Veco	Round Alnico Type Speakers 8Ω 0.5W	Φ57x8.3H mm	8	0.5W	1.0W	300~12000

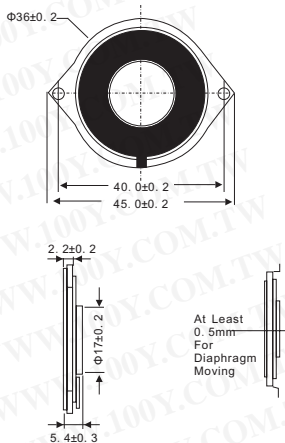

Dimension	Outer diameter 36 mm baffle opening 32.3mm. Height refer to drawing weight 8.7 gram
Magnet	Material rare earth size Φ12.5x1.5 mm
Nominal impedance	8 Ohm ±15% at Φ12.5x1.5 mm
Power rating	Normal 2.0 W. Maximum 3.0 W
Lowest resonant frequency	470±94 Hz
Output sound pressure level (S. P. L.)	86 ± 3 dB/1 Watt 1 Meter Average at 500, 600, 800, 1000 Hz
Frequency range	300~20K Hz. Average SPL-10 dB
Distortion	5% Maximum at 1000 Hz 2.0 W.
Abnormal sound test	Must be normally tested by 4.0 volts sine wave
Load test	White noise with weighted filter 4.0 volts (RMS) 24 Hrs.
Operation temperature	-25°C ~ +60°C
Storage temperature	-40°C~+70°C
Polarity	Diaphragm shall move forward when apply a positive DC Current to the "+" or "marked" Terminal

Part No.	Product No.	Description	Dia.*Depth	Impedance Ω±15%	Nini-Watts Nor.(mW)	Nini-Watts Max.(mW)	Frequency Range(Hz)
24858	F36M84B	Round Alnico Type Speakers	36*5.4	8Ω±15%	2W	3W	300~20K
24940	F40M58B	Round Alnico Type Speakers	40*6.2	8Ω±15%	2W	3W	280~5000
24857	F40M90B	Round Alnico Type Speakers	40*4.9	8Ω±15%	1W	2W	280~5000

- We provide a wide range of products to development and maintenance engineers in all type of business
- If you cannot find the components you want on the catalogue, please call us.

Taiwan: 886-3-5753170  
Shanghai: 021-54151736 Shenzhen: 0755-83298787

**Centenary Materials**  
Waiting for your phone call



T E L : Taiwan: 886-3-5753170  
F A X : Taiwan: 886-3-5753172  
E-mail : Taiwan: [us\\_sale@100y.com.tw](mailto:us_sale@100y.com.tw)

Shenzhen: 86-755-83298787  
Shenzhen: 86-755-83640655  
Shenzhen: [100y@163.com](mailto:100y@163.com)

Shanghai: 86-21-54151736  
Shanghai: 86-21-64605107  
Shanghai: [100y-1@163.com](mailto:100y-1@163.com)