

Sensors & Transducers

Proximity Switch-Inductive

Detailed product specifications are available on: us.100y.com.tw

Part No.	Product No.	Manufacturer	Description	Size	Sensing Distance	Output
10698	E2E-X8MD1-N	OMRON	OMRON_Proximity Switch-Inductive	M12-Metal Thread	8mm	NO Multi-Overload Circuit Protection
48567	E2E-X8MD1S-M1-N	OMRON	OMRON_Proximity Switch-Inductive		8mm	NO
38112	E2E-X8MD2	OMRON	OMRON_Proximity Switch-Inductive	8mm	M12	NC
41663	E2EC-CR8D1	OMRON	Programmable Controller-compatible	3dia	0.8mm	NO

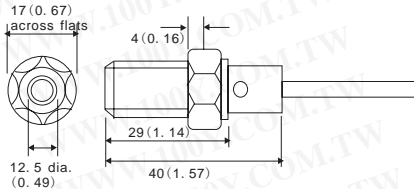

- Rugged, watertight plastic housing offers good chemical resistance and with-stands
- Wide operating voltages: 10 to 30 VDC and 20 to 264 VAC
- Operation indicator on all models
- Short-circuit protection available on all DC and some AC models



Part number	E2F-X2 . . .
Supply voltage	10 to 30 VDC
Current consumption	17 mA max.
Detectable object type	Metallic objects
Weight with cable	Approx. 50 g (1.8 oz)
Ambient operating temperature	-25°C to 70°C (-13° to 158°F)
Vibration	10 to 55 Hz, 1.5 mm (0.06 in) double amplitude
Shock	Approx. 100 G
Indicators	Target Present (red LED)
Response frequency	1.5 kHz
Standard target size (mild steel, L x W x H)	12 x 12 x 1 mm (0.47 x 0.47 x 0.04 in)

Part No.	Product No.	Manufacturer	Description	Size	Sensing Distance	Output
14220	E2F-X2Y1	OMRON	Proximity Switch-Inductive-Vin:10-30Vdc & 24-24030VAC, AC-2 Output	M12-Plastic thread	2mm	NO

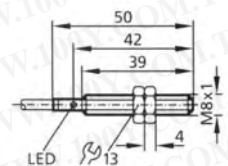
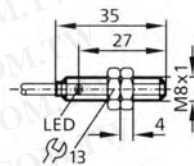
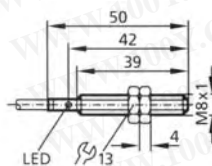
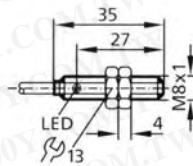
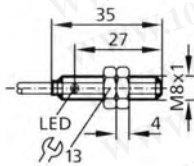

IE5082/IEB3001-ANOG IE5107/IEC3002-ANOG IE5202/IE-2002-FROG IE5207/IEB2001-AROG IE5222/IEA2001-FROG

Electrical design	DC NPN	DC NPN	DC PNP/NPN	DC PNP/NPN	DC
Output	normally open	normally open	normally open / closed programmable	normally open	normally open / closed programmable
Operating voltage [V]	10...36 DC	10...36 DC	5...36 DC	10...36 DC	5...36 DC
Current rating [mA]	200	200	200	200	200
Short-circuit protection	—	—	—	—	—
Reverse polarity protection / Overload protection	—	—	—	—	—
Voltage drop [V]	< 1	< 1	< 4,6	< 2,6	< 4,6
Current consumption [mA]	< 15 (24V)	< 15 (24V)	< 0,8	< 0,8	< 0,8
Real sensing range [mm]	1 ±10%	2 ±10%	2 ±10%	1 ±10%	1 ±10%
Operating distance [mm]	0...0,8	0...1,6	0...1,6	0...0,8	0...0,8
Operating temperature [°C]	-25...+80	-25...+80	-25...+80	-25...+80	-25...+80
Protection	IP 67	IP 67	IP 67, III	IP 67	IP 67, III
Housing material	brass Optalloy-platedPBTP	PBTP	Pocan ARNITEL	brass Optalloy-platedPBTP	brass Optalloy-platedactive face: PBTP
Connection	PVC cable / 2m; 3 x 0,14mm ²	PVC cable / 2m; 3 x 0,14mm ²	PUR/PVC cable / 2m; 2 x 0,14mm ²	PVC cable / 2m; 2 x 0,14mm ²	PUR/PVC cable / 2m; 2 x 0,14mm ²
Wiring	Core colours BN brown BU blue BK black				

Part No.	Product No.	Manufacturer	Description	Size	Sensing Distance	Output
4851	IE5082/IEB3001-ANOG	IFM	Proximity Switch-Inductive-Vin:10-36Vdc , DC-3 Output	M8-Metal Thread	1mm	NO NPN-No Overload Circuit Protection
4357	IE5107/IEC3002-ANOG	IFM	Proximity Switch-Inductive-Vin:10-36Vdc , DC-3 Output	M8-Plastic thread	2mm	NO NPN-No Overload Circuit Protection
4853	IE5202/IE-2002-FROG	IFM	Proximity Switch-Inductive-Vin:5-36Vdc , DC-2 Output	M8-Plastic thread	2mm	NO/NC NPN/PNP-No Overload Circuit Protection
14617	IE5207/IEB2001-AROG	IFM	Proximity Switch-Inductive	M8	1mm	DC PNP/NPN
4852	IE5222/IEA2001-FROG	IFM	Proximity Switch-Inductive-Vin:5-36Vdc , DC-2 Output	M8-Metal	1mm	NO/NC NPN/PNP-No Overload Circuit Protection



T E L : Taiwan : 886-3-5753170
 F A X : Taiwan : 886-3-5753172
 E-mail : Taiwan : us_sale@100y.com.tw

Shenzhen : 86-755-83298787
 Shenzhen : 86-755-83640655
 Shenzhen : 100y@163.com

Shanghai : 86-21-54151736
 Shanghai : 86-21-64605107
 Shanghai : 100y-1@163.com