

Sockets & Accessories

QFP/FPQ Burn-In/Test Sockets

Detailed product specifications are available on: us.100y.com.tw

Part No.	Product No.	Manufacturer	Description	Pins/Pitch	Temperature Endurance °C	Suitable IC package
20072	IC51-1284-1433		PCB For : IC51-1284-1433-10 Socket	TSOP		128P/0.5mm
17558	IC51-1284-1433-10	YAMAICHI	YAMAICHI_QFP Sockets	128P/0.5mm	-40°C to +150°C	QFP_128P/0.5mm
39109	IC51-1284-844	YAMAICHI	120P QFP-120P Test Sockets	128P/0.8mm	-55°C to +170°C	QFP
15526	IC51-1444-1014-3	YAMAICHI	144P QFP Socket	144P/0.65	-55°C-70°C	QFP
27516	IC51-1444-1354-7	YAMAICHI	144P QFP Socket	144P/0.5		QFP
39107	IC51-1497-KS11444	YAMAICHI	120P QFP-120P Test Sockets	120P/0.8mm	-55°C to +170°C	QFP

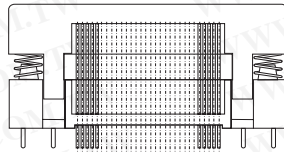
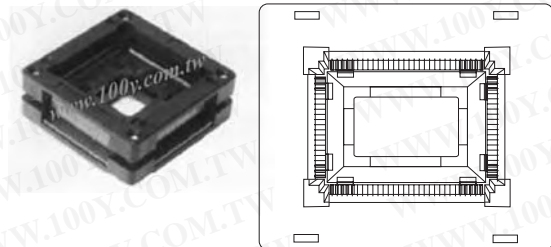

MATERIAL

Body: PEI, PES
Contact: BeCu, Au plating (Ni-base)

SPECIFICATIONS

Contact resistance: Initial 100Ωm (At 10mA)
Maximum voltage: AC700V RMS (for 1 minute)
* Below 0.5mm Pitch
AC500V RMS (for 1 minute)
Insulation resistance: 1,000MΩ or higher (At DC 500V)
Rated current: 1A
Operating temperature range: -60°C ~ +150°C
Terminal strength against pulling: 0.5kg (1 minute)
Insertion: Min. 10,000 times (Mechanical)

Part No.	Product No.	Manufacturer	Description	Pins/Pitch	Temperature Endurance °C	Suitable IC package
39103	OTQ-100-0.5-11	ENPLAS	QFP-100P Test Socket	100Pins / 0.5mm	-60°C ~ +150°C	QFP
41674	OTQ-100-0.65-05	ENPLAS	QFP-100P IC Test socket	100Pins / 0.65mm	-60°C ~ +150°C	QFP
39104	OTQ-100-0.65-22	ENPLAS	QFP-100P Test Socket	100Pins / 0.65mm	-60°C ~ +150°C	QFP
39089	OTQ-112-0.65-02	ENPLAS	QFP-112P Test Socket	112Pins / 0.65mm	-60°C ~ +150°C	QFP
39095	OTQ-32-0.8-02	ENPLAS	QFP-32P Test Socket	32Pins / 0.8mm	-60°C ~ +150°C	QFP
39096	OTQ-44-0.8-04	ENPLAS	QFP-44P Test Socket	44Pins / 0.8mm	-60°C ~ +150°C	QFP
39097	OTQ-48-0.5-03	ENPLAS	QFP-48P Test Socket	48Pins / 0.5mm	-60°C ~ +150°C	QFP
39098	OTQ-52-0.65-03	ENPLAS	QFP-52P Test Socket	52Pins / 0.65mm	-60°C ~ +150°C	QFP
39099	OTQ-64-0.65-04	ENPLAS	QFP-64P Test Socket	64Pins / 0.65mm	-60°C ~ +150°C	QFP
41709	OTQ-80-0.5-02	ENPLAS	QFP-80P IC Test socket	05mm/0.2mm	-60°C ~ +150°C	QFP
39100	OTQ-80-0.5-05	ENPLAS	QFP-80P Test Socket	80Pins / 0.5mm	-60°C ~ +150°C	QFP
39101	OTQ-80-0.65-05	ENPLAS	QFP-80P Test Socket	80Pins / 0.65mm	-60°C ~ +150°C	QFP
39102	OTQ-88-0.65-05	ENPLAS	QFP-80P Test Socket	80Pins / 0.65mm	-60°C ~ +150°C	QFP

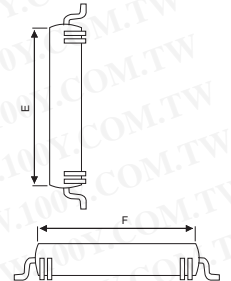
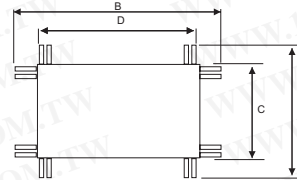
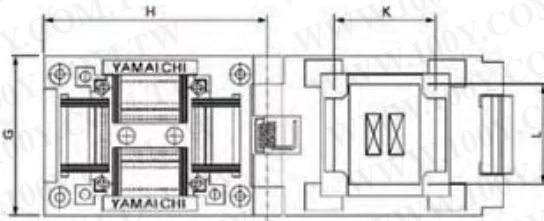

Specifications

As specifications for this product differ by pitch and material-mix, please contact our Sales Department for detailed information.
Insulation Resistance: 1,000MΩ min. at 100V DC, 500V DC
Dielectric Withstanding Voltage: for 1 minute at 100V AC, 500V AC, 700V AC
Contact Resistance: 30mΩ max. at 10mA/20mV max.
Operating Temperature Range: (PEI/PSF) -40°C to +150°C
(PES) -55°C to +170°C
(PEI) -55°C to +170°C
Mating Cycles: 10,000 insertions min.

Materials and Finish

Housing: Polysulphone (PSF) Polyethersulphone (PES)
Polyetherimide (PEI)
Contacts: Beryllium Copper (BeCu)
Plating: Gold over Nickel

Features

High reliability, durability and temperature range Custom made also available for high pin count and fine-pitch IC packages

Part No.	Product No.	Description
27517	PCB-E	IC51-1444-1354-7 Burn-In Board

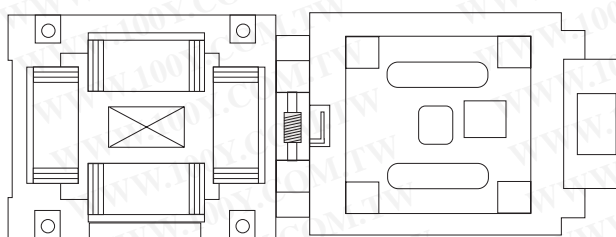

Part No.	Product No.	Description	Pins/Pitch	Temperature Endurance °C
11103	QFP-144	Clam Shell ZIF QFP	144P	Up to 170°C



T E L : Taiwan: 886-3-5753170
F A X : Taiwan: 886-3-5753172
E-mail: Taiwan: us_sale@100y.com.tw

Shenzhen: 86-755-83298787
Shenzhen: 86-755-83640655
Shenzhen: 100y@163.com

Shanghai: 86-21-54151736
Shanghai: 86-21-64605107
Shanghai: 100y-1@163.com