

Semiconductors-Discretes

High Voltage Rectifier Bridge

Detailed product specifications are available on: us.100y.com.tw

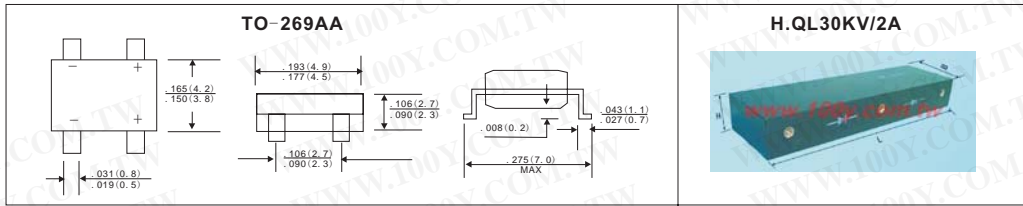

Part No.	Product No.	Description	Size L*B*H(mm)	V _{rrm} (kV)	I _o (A)	V _{fm}	I _{fsm} (A)
47156	B8S	Silicon Rectifier Bridge		800V	0.5A	1V	30A
15454	H.QL30KV/2A	High Voltage Silicon Rectifier Bridge	244*73*35	30V	2A	30V	40A

Press-Fit Power Rectifiers

Detailed product specifications are available on: us.100y.com.tw

DACO_Press-Fit Power Rectifiers

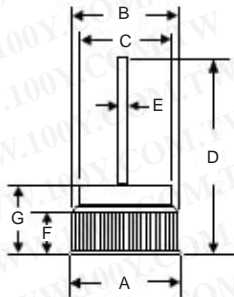

DIM	DIMENSIONS				NOTE
	INCHES		MM		
	MIN	MAX	MIN	MAX	
A	0.504	0.520	12.80	13.20	
B	0.502	0.504	12.76	12.80	
C	0.437	0.453	11.10	11.50	
D	0.984 Min		25.00 Min		
E	0.050 Typ		1.28 Typ		
F	0.156	0.171	3.95	4.35	
G	0.303	0.319	7.70	8.10	



Part No.	Product No.	Manufacturer	Description	V _{rrm}	I _o (A)	I _{fsm} (A)	Package
26639	PFBM2501(R)	DACO	DACO_SILICON RECTIDIER	50	25	400	BOSCH(M TYPE)
26640	PFBM2502(R)	DACO	DACO_SILICON RECTIDIER	100	25	400	BOSCH(M TYPE)
26641	PFBM2503(R)	DACO	DACO_SILICON RECTIDIER	200	25	400	BOSCH(M TYPE)
26642	PFBM2504(R)	DACO	DACO_SILICON RECTIDIER	400	25	400	BOSCH(M TYPE)
26643	PFBM2505(R)	DACO	DACO_SILICON RECTIDIER	600	25	400	BOSCH(M TYPE)
26644	PFBM2506(R)	DACO	DACO_SILICON RECTIDIER	800	25	400	BOSCH(M TYPE)
26645	PFBM2507(R)	DACO	DACO_SILICON RECTIDIER	1000	25	400	BOSCH(M TYPE)
26646	PFBM3501(R)	DACO	DACO_SILICON RECTIDIER	50	35	600	BOSCH(M TYPE)
26647	PFBM3502(R)	DACO	DACO_SILICON RECTIDIER	100	35	600	BOSCH(M TYPE)
26648	PFBM3503(R)	DACO	DACO_SILICON RECTIDIER	200	35	600	BOSCH(M TYPE)
26649	PFBM3504(R)	DACO	DACO_SILICON RECTIDIER	400	35	600	BOSCH(M TYPE)
26650	PFBM3505(R)	DACO	DACO_SILICON RECTIDIER	600	35	600	BOSCH(M TYPE)
26651	PFBM3506(R)	DACO	DACO_SILICON RECTIDIER	800	35	600	BOSCH(M TYPE)
26652	PFBM3507(R)	DACO	DACO_SILICON RECTIDIER	1000	35	600	BOSCH(M TYPE)
26653	PFBM5001(R)	DACO	DACO_SILICON RECTIDIER	50	50	800	BOSCH(M TYPE)
26654	PFBM5002(R)	DACO	DACO_SILICON RECTIDIER	100	50	800	BOSCH(M TYPE)
26656	PFBM5003(R)	DACO	DACO_SILICON RECTIDIER	200	50	800	BOSCH(M TYPE)
26657	PFBM5004(R)	DACO	DACO_SILICON RECTIDIER	400	50	800	BOSCH(M TYPE)
26658	PFBM5005(R)	DACO	DACO_SILICON RECTIDIER	600	50	800	BOSCH(M TYPE)
26659	PFBM5006(R)	DACO	DACO_SILICON RECTIDIER	800	50	800	BOSCH(M TYPE)
26660	PFBM5007(R)	DACO	DACO_SILICON RECTIDIER	1000	50	800	BOSCH(M TYPE)

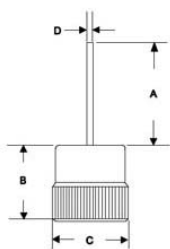

DIM	DIMENSIONS				NOTE
	INCHES		MM		
	MIN	MAX	MIN	MAX	
A	0.834	0.857	21.19	21.78	
B	0.336	0.343	8.53	8.70	
C	0.398	0.400	10.11	10.16	
D	0.050	0.051	1.29	1.30	



Part No.	Product No.	Manufacturer	Description	V _{rrm}	I _o (A)	I _{fsm} (A)	Package
26597	PFL2501(R)	DACO	DACO_INDUSTRIAL PRESS-FIT POWER RECTIFIER	50	25	400	LUCAS
26598	PFL2502(R)	DACO	DACO_INDUSTRIAL PRESS-FIT POWER RECTIFIER	100	25	400	LUCAS
26599	PFL2503(R)	DACO	DACO_INDUSTRIAL PRESS-FIT POWER RECTIFIER	200	25	400	LUCAS
26600	PFL2504(R)	DACO	DACO_INDUSTRIAL PRESS-FIT POWER RECTIFIER	400	25	400	LUCAS
26601	PFL2505(R)	DACO	DACO_INDUSTRIAL PRESS-FIT POWER RECTIFIER	600	25	400	LUCAS



T E L : Taiwan: 886-3-5753170
 F A X : Taiwan: 886-3-5753172
 E-mail : Taiwan: us_sale@100y.com.tw

Shenzhen: 86-755-83298787
 Shenzhen: 86-755-83640655
 Shenzhen: 100y@163.com

Shanghai: 86-21-54151736
 Shanghai: 86-21-64605107
 Shanghai: 100y-1@163.com