

# Resistors & Potentiometers

## Surface Mount - Trimmers

Detailed product specifications are available on: [us.100y.com.tw](http://us.100y.com.tw)



Metal Glazed Semifixed Variable Resistors  
TG: 4O Chip type cermet.

**Features:**

- Space saving . Low profile
- Sealing type (6mm) to prevent dust.
- Long operation life. Low tempcoefficient.
- Easy adjustment by standard screwdriver.

**Applications:**

- Audio & video products: such as TV receivers. VCR, satellite receivers etc.
- Camera, video camera.
- Computer: notebook, etc.
- Instrument industrial equipment.

Part No.	Product No.	Description	Resistance(Ω)	Tolerance(±)
9813	RVG4J04-301VM-TC	Metal Glazed Semifixed Variable Resistor	300 ohm	±30%

## Cermet Potentiometers

Detailed product specifications are available on: [us.100y.com.tw](http://us.100y.com.tw)

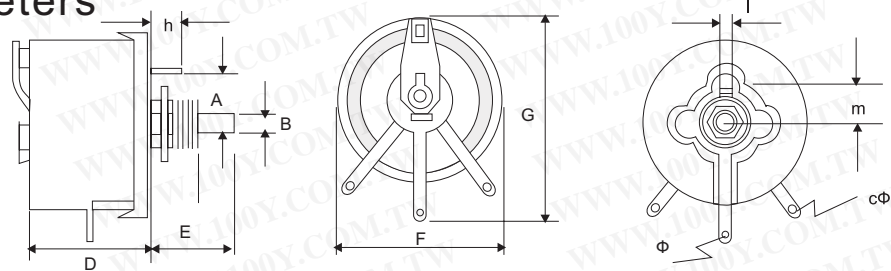

RATED WATTS	DIMENSIONS (m/m)										REMARK
	A	B	D	E	F	G	h	I	cΦ	Φ	
25W	12	6.5	32	25	40	43	5	5	3	3	2Ω~1KΩ
50W	12	6.5	35	25	62	72	11	5	4	5	2Ω~1KΩ
100W	12	6.5	40	28	85	95	11	5	4	5	2Ω~1KΩ

Part No.	Product No.	Manufacturer	Description	Resistance (Ω)	Power rating (W)	Tolerance (±)
12771	RV100W100EJ		Cermet Potentiometers	100 ohm	100W	
12770	RV100W10E0J		Cermet Potentiometers	10 ohm	100W	±5%
28348	RV100W1E00J		Cermet Potentiometers	1ohm	100W	±5%
12772	RV100W1K00J		Cermet Potentiometers	1K ohm	100W	+/- 5%
21949	RV100W300EJ		Cermet Potentiometers	300ohm	100W	±5%
12766	RV25W100EJ		Cermet Potentiometers	100 ohm	25W	
12764	RV25W10E0J		Cermet Potentiometers	10 ohm	25W	
23396	RV25W1100J		Cermet Potentiometers	1.1K ohm	25W	±5%
35896	RV25W16E0J		Cermet Potentiometers	16 ohm	25W	±5%
12765	RV25W1K00J		Cermet Potentiometers	1K ohm	25W	
40819	RV25W750EJ	LIKET	Cermet Potentiometers	750 ohm	25W	±5%
12768	RV50W100EJ		Cermet Potentiometers	100 ohm	50W	
12767	RV50W10E0J		Cermet Potentiometers	10 ohm	50W	
12769	RV50W1K00J		Cermet Potentiometers	1K ohm	50W	
17016	RV50W300EJ		Cermet Potentiometers	300 ohm	50W	
23266	RV50W500EJ		Cermet Potentiometers	500 ohm	50W	±5%
23696	RV50W50E0J		Cermet Potentiometer	50Ω	50W	±5%



- Power consume: (70°C) 5W
- Resistance range: 5Ω~10KΩ
- Max working voltage: 200V
- Rotation angle: 310°±10°
- Engine life: 18000 Cycle

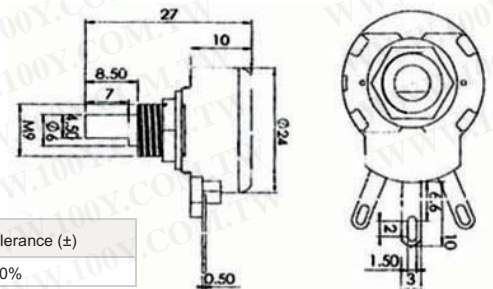

Part No.	Product No.	Description	Resistance (Ω)	Power rating (W)	Tolerance (±)
40792	WX24-5W-10KΩ	Single-Turn Wire Wound Potentiometer	10KΩ	5W	±10%

