



Relays & Solenoids

SIL PCB Reed Relays

Detailed product specifications are available on: us.100y.com.tw



- Ultra miniature size industry standard footprint (SH series)
- Miniature size industry standard package (DG series)
- Optional shielding and diodes (DG, SH series)
- UL models available

Power (W) max. : 10
 Voltage (VDC) max. : 200
 Switching current (A) max. : 0.5
 Carry current (A) max. : 1.0
 Operate time (mS) max (incl. bounce) : 1.0
 Release time (mS) max. : 0.5
 Electrical life: : Low level 10⁸ (10mVDC, 10μA)
 Rated load 6x10⁵ (20VDC, 0.5A)

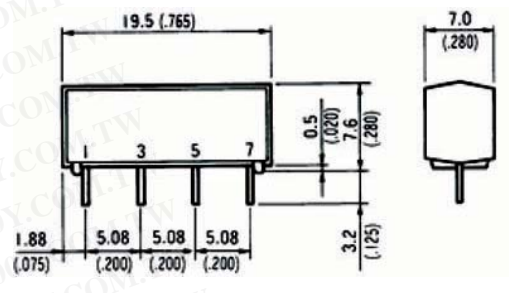
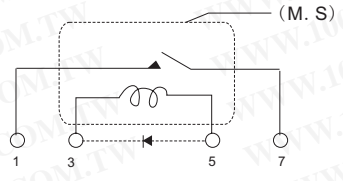

Part No.	Product No.	Description	L*W*H(mm)	Contact Type	Carry current (A)	Coil Volt.	Safety criterion
29347	DG1A24BWD	SIL PCB Reed Relay	19*7*7.6(mm)	1 Form A	1.0A	24V	UL

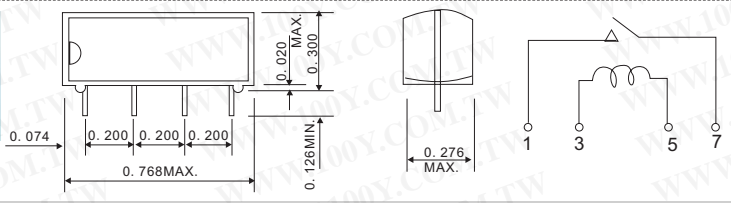

Contact rating: Power: 10W max.
 Voltage: DC 500V max.
 Current switching: 0.5
 carry only: 1.0 Amax
 Operate temperature range: -30°C to +85°C

Part No.	Product No.	Description	L*W*H(mm)	Contact Type	Carry current (A)	Coil Volt.	Safety criterion
29346	DGS2248-1	ALEPH_SIL PCB Reed Relay	19*7*7.6(mm)	1 Form A	1A/500Vdc	5V	UL
39300	DGS2248-2	ALEPH_SIL PCB Reed Relay	19*7*7.6(mm)	1 Form A	1A/500Vdc	12V	UL
39297	DGS2248-3	ALEPH_SIL PCB Reed Relay	19*7*7.6(mm)	1 Form A	1A/500Vdc	24	UL

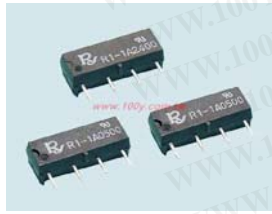

- FEATURES:**
- Miniature reed relay, cost-effective, switching solution
 - Pin out 1357 & 1267
 - Diode version are available for customer selection
 - Washable type
 - Using at security system, modem and other telecommunication products

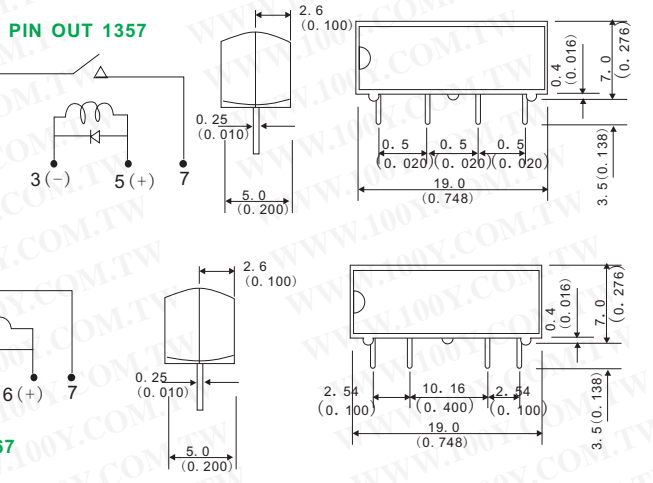

GENERAL DATA

Insulation Resistance: 1,000 MW Min. (DC 100V)
 Contact Material: Silver- Cadmium Oxide as standard.
 Contact Resistance: 150 milliohms max. (initial value)
 Switching Current: 1A, 2A, 1B : 0.5ADC Max., 1C : 0.2ADC Max.
 Carry Current: 1A, 2A, 1B : 1.0ADC Max., 1C : 0.5ADC Max.
 Switching Power: 1A, 2A, 1B : 10VA Max. 1C : 3VA Max.
 Operation Time: 1 ms max.
 Release Time: 0.5 ms max.
 Temperature Range: - 40°C~+85°C
 Weight: 1.4 grams

Part No.	Product No.	Manufacturer	Description	L*W*H(mm)	Contact Type	Carry current (A)	Coil Volt.	Safety criterion
10344	R1-1A0500	RAYEX	SIL PCB Reed Relays	19*7*5	1PST-NO	1A	5Vdc	UL
10345	R1-1A1200	RAYEX	SIL PCB Reed Relays 1PST-NO COIL:12Vdc	19*7*5	1PST-NO	1A	12Vdc	UL
10346	R1-1A2400	RAYEX	SIL PCB Reed Relays 1PST-NO COIL:24Vdc (PIN OUT 1357)	19*7*5	1PST-NO	1A	24Vdc	UL
16901	R1-1A2450	RAYEX	SIL PCB Reed Relays 1PST-NO COIL:24Vdc (PIN OUT 1267)	19*7*5	1PST-NO	1A	24Vdc	UL



- FEATURES:**
- Industry standard footprint
 - High power contacts on some models
 - UL models available

CONTACT RATINGS

Power (W) max. : 10
 Voltage (VDC) max. : 200
 Switching current (A) max. : 0.5
 Carry current (A) max. : 1.0
 Operate time (mS) max (inch, bounce) : 1.0
 Release time (mS) max. : 0.5
 Electrical life: low level: 10⁸ (10mVDC, 10μA)
 Rated load: 6x10⁵ (20VDC, 0.5A)

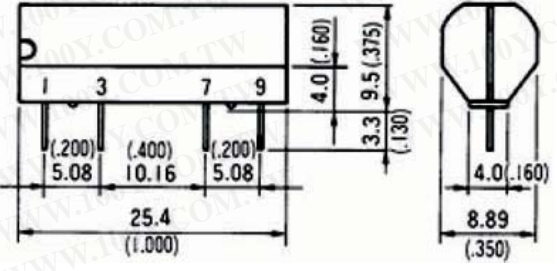
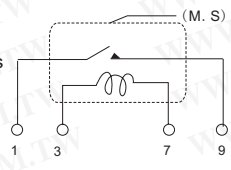

Part No.	Product No.	Description	L*W*H(mm)	Contact Type	Carry current (A)	Coil Volt.	Safety criterion
29350	SD1A05AWJ	SIL PCB Reed Relay	25.4*9.5(mm)	1 Form A	1.0A	5V	UL



T E L : Taiwan: 886-3-5753170
 F A X : Taiwan: 886-3-5753172
 E-mail : Taiwan: us_sale@100y.com.tw

Shenzhen: 86-755-83298787
 Shenzhen: 86-755-83640655
 Shenzhen: 100y@163.com

Shanghai: 86-21-54151736
 Shanghai: 86-21-64605107
 Shanghai: 100y-1@163.com