



5mm LED

Detailed product specifications are available on: us.100y.com.tw

FEATURES

- Exceptional brightness
- Wide viewing angle
- Outstanding material efficiency
- Low forward voltage
- CMOS/MOS compatible
- TTL compatible
- Deep red color

APPLICATIONS

- Bright ambient lighting conditions
- Moving message panels
- Portable equipment
- General use

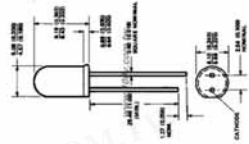

Part No.	Product No.	Manufacturer	Description	If max. mA	Wave length (nm)	Light (mcd)	Typical Vf/If	View Angle
33563	HLMP-D101	Agilent	High Intensity, Double Heterojunction AlGaAs Red LED Lamps	30mA	645nm	70mcd	1.8V/20mA	65

FEATURES

- Well defined spatial radiation patterns
- Viewing angles: 6°, 15°, 23°, 30°
- High luminous output
- Colors: 590 nm amber; 605nm orange
615 nm reddish-orange
625 nm red
- High operating temperature: T_J LED=+130°C
- Superior resistance to moisture
- Package options: with or without lead stand-offs

APPLICATIONS

- Traffic management
Traffic signals; pedestrian signals
work zone warning lights; variable message signs
- Commercial outdoor advertising:
signs ; marquees
- Automotive:
Exterior and interior lights

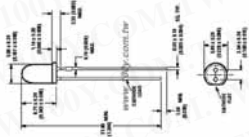

Part No.	Product No.	Manufacturer	Description	If max. mA	Wave length (nm)	Light (mcd)	Typical Vf/If	View Angle
33543	HLMP-EH24-SV000	Agilent	T-13/4 (5 mm) Precision Optical Performance AlInGaP LED Lamps	50mA	615nm	1500mcd	1.94V	23

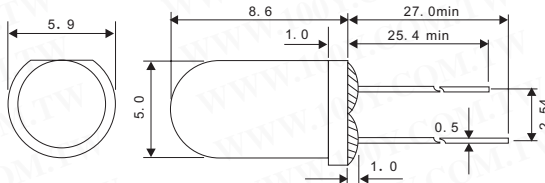

Part No.	Product No.	Manufacturer	Description	Emitting Color	Lens Color	If max. mA	Wave length (nm)	Light (mcd)	Typical Vf/If	View Angle
16187	L503WC	JOINSCAN	φ5 LED	Red	Limpid	20mA	660nm	11-35	1.8V	Diffusion
14289	L503YC-S	JOINSCAN	φ5 LED	Yellow Forward Orange	Limpid	20mA	600nm	11-35	2.1V	Diffusion

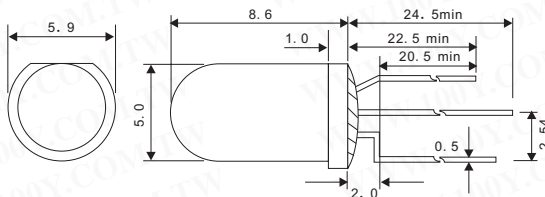

Part No.	Product No.	Manufacturer	Description	Emitting Color	Lens Color	If max. mA	Wave length (nm)	Light (mcd)	Typical Vf/If	View Angle
3943	L505CM	JOINSCAN	5mm LED	Orange+Green	Milky	20	635+565	14~30	2.2	Diffusion



CHARACTERS

- High intensity
- Viewing angle 15°
- Reliable and rugged
- Standard 3mm diameter package

ITEM	MATERIALS
Resin (mold)	Epoxy
Lens color	Water transparent
Lead frame	Ag plating Iron alloy
Dice	InGaN

Part No.	Product No.	Manufacturer	Description	Emitting Color	Lens Color	If max. mA	Wave length (nm)	Light (mcd)	Typical Vf/If	View Angle
31131	LA-503B2CA-2D-01	BRTLED	φ5 LED Blue	Super Blue	Water Transparent	20mA	468	3500mcd	3.6V/20mA	15
31134	LA-503V4CA-1D-01	BRTLED	φ5 LED Super Fresh Red	Super Fresh Red	Water Clear	20mA	635	6000	2.25V/20mA	
37491	LA-504W1CA-1B-02	STONE	φ5 LED Super White	Super White	Water Transparent	20mA		10000	3.2V/20mA	

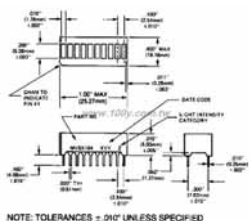

FEATURES

- Large segments, closely spaced
- End-stackable
- Fast switching-excellent for multiplexing
- Low power consumption
- Directly compatible with IC's
- Wide viewing angle
- Standard .3-inch DIP lead spacing
- Categorized for luminous intensity

DESCRIPTION

The MV5X164 series is a 10 segment bargraph display with separate anodes and cathodes for each light segment. The packages are end-stackable.



Part No.	Product No.	Manufacturer	Description	Lens Color	If max. mA	Wave length (nm)	Typical Vf/If
35510	MV53164	Fairchild	BARGRAPH DISPLAYS	Yellow	10mA	585nm	2.0V/10mA

● We provide various product for your choice and help you develop infinite commercial chance!
[Http://us.100y.com.tw/](http://us.100y.com.tw/)
Centenary Materials
 Waiting for your phone call



T E L : Taiwan: 886-3-5753170
 F A X : Taiwan: 886-3-5753172
 E-mail : Taiwan: us_sale@100y.com.tw

Shenzhen: 86-755-83298787
 Shenzhen: 86-755-83640655
 Shenzhen: 100y@163.com

Shanghai: 86-21-54151736
 Shanghai: 86-21-64605107
 Shanghai: 100y-1@163.com