



# PHILIPS\_Projection Lamps

Detailed product specifications are available on: [us.100y.com.tw](http://us.100y.com.tw)



- Packing type: 1 Carton
- Pieces per pack: 1
- Packing configuration: 10X5F
- Packing per outerbox: 50

- Cap -Base: GX5.3
- Reflector finish: smooth
- Main application: projection

**PHILIPS**

Part No.	Product No.	Manufacturer	Description	ANSI	Watts (W)	Voltage (V)	Filament Design
39400	PHILIPS-13163-24V250W	PHILIPS	PHILIPS_Projection lamps	13163	250W	24V	GX5.3
39401	PHILIPS-13629-21V150W	PHILIPS	PHILIPS_Projection lamps	13629	150W	21V	GX5.3
39404	PHILIPS-6423-15V150W	PHILIPS	PHILIPS_Projection lamps	6423	150	15	GZ6.35
39402	PHILIPS-6834-12V100W	PHILIPS	PHILIPS_Projection lamps	6834	100	12	GZ6.35



- Packing type: 1 Carton
- Pieces per pack: 1
- Packing configuration: 10X10F
- Packing per outerbox: 100

- Cap -Base: G6.35
- Bulb material: Quartz-UV open
- Main application: projection

**PHILIPS**

Part No.	Product No.	Manufacturer	Description	ANSI	PH. Ref.	Color Temp. K	Watts (W)	Voltage (V)	LumensLm	Ave. Life (hr)	Filament Design
39398	PHILIPS-13700-24V275W	PHILIPS	PHILIPS_Projection Lamps	13700			275W	24V			G6.35
39388	PHILIPS-6550-15V150W	PHILIPS	PHILIPS_Projection Lamps	6550			150W	15V			G6.35
39386	PHILIPS-7023-12V100W	PHILIPS	PHILIPS_Projection Lamps	7023			100W	12V			GY6.35
39382	PHILIPS-7027-12V50W	PHILIPS	PHILIPS_Projection Lamps	7027			50W	12V			G6.35
39375	PHILIPS-7158-24V150W	PHILIPS	PHILIPS_Projection Lamps	7158			150W	24V			G6.35
39380	PHILIPS-7387-6V10W	PHILIPS	PHILIPS_Projection Lamps	7387			10W	6V			G4
39378	PHILIPS-7388-6V20W	PHILIPS	PHILIPS_Projection Lamps	7388			20	6			G4
39383	PHILIPS-7724-12V100W	PHILIPS	PHILIPS_Projection Lamps	7724			100W	12V			GY6.35
27916	PHILIPS-BRL/BCD	PHILIPS	PHILIPS_Halogen Capsule Lamp-Photo/Projection Lamp	BRL	7027	3400	50W	12V	1500	50	G6.35



- Packing Type: 1CT (1 Carton)
- Packing Configuration: 10X10F
- ANSI Code: EVC/FGX
- LIF Code: M33

- Bulb material: Quartz-UV open
- Filament shape: Flat
- Burning position: s90
- Main application: Projection

**PHILIPS**

Part No.	Product No.	Manufacturer	Description	Watts (W)	Voltage (V)
42980	PHILIPS-EHJ-24V/250W	PHILIPS	PHILIPS_Projection lamps	250	24

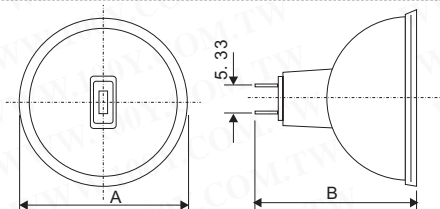

Type	Philips	ANSI	(V)	(W)	Dimensions		[WD] (mm)	(K)	(h)
					A Max. (mm)	B Max. (mm)			
EJA 21V 150W	14527	EJA	21	150	50.7	44.5	28	3400	40
EJA 21V 150W	13629	EKE	21	150	50.7	44.5	44.5	3250	200

**PHILIPS**



Part No.	Product No.	Manufacturer	Description	ANSI	PH. Ref.	Color Temp. K	Watts (W)	Voltage (V)	Ave. Life (hr)	Filament Design	Dia. * Mol (mm)	Fig No.
14544	PHILIPS-EJA	PHILIPS	Photo/Projection Lamp	EJA	EJA	3350	150W	21V	40	GX5.3		25
16686	PHILIPS-EKE-13629	PHILIPS	PHILIPS_Dichroic Open Faced Halogen Lamp -Photo/Projection lamp	EKE	13629	3250	150	21	200h	GX5.3	51*44.5	

Amp/watt: 8.33A/100W

Base: G6.35-~C" Miniature 2-pin round 1mm, 6.35mm centered (found on glass base bulbs)

**PHILIPS**



Part No.	Product No.	Manufacturer	Description	ANSI	Color Temp. K	Watts (W)	Voltage (V)	Ave. Life (hr)	Filament Design	Dia. * Mol (mm)
16603	PHILIPS-JCR12V100W/10H	PHILIPS	Philips Dichroic Open Faced Lamp	JCR	3100	100W	12V	1000h	GZ6.35	50*42mm

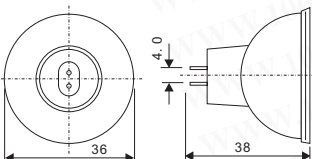

Part No.	Product No.	Manufacturer	Description	ANSI	Color Temp. K	Watts (W)	Voltage (V)	Ave. Life (hr)	Filament Design	Dia. * Mol (mm)
27917	PHILIPS-JCR12V20W	PHILIPS	PHILIPS_Projection Lamp	JCR	2950	20W	12V	2000	GZ4	36*38mm

**PHILIPS**

