



# Uninsulated Nylon Bullet Male/ Female Connectors- Bullet Type

Detailed product specifications are available on: [us.100y.com.tw](http://us.100y.com.tw)



Open barrel terminals (female & male)  
 LR: Loose piece, standard chemical treatment (brass finish)  
 LT: Loose piece, tin plated  
 SR: Strip form, standard chemical treatment (brass finish)  
 ST: Strip form, tin plated  
 Terminal material: brass

ITEM NO.	MATCHING	DIMENSION <sup>Inch</sup> / <sub>mm</sub>			FIGURE
		W	F	L	
351LR	Φ3.5	.138 3.5	.331 8.4	.646 16.4	
352LR	Φ3.5	.138 3.5	.264 6.7	.681 17.3	
401LR	Φ4.0	.157 4.0	.331 8.4	.701 17.8	
402LR	Φ4.0	.156 3.95	.264 6.7	.669 17.0	

Part No.	Product No.	Description	Material	Size L*W(mm)	Cable No.	Type
11033	351LR	Uninsulated Nylon Bullet Male Connector	Brass Finish	16.4*3.5	16-14AWG(2mm <sup>2</sup> )	Male
11187	352LR	Uninsulated Nylon Bullet Female Connector	Brass Finish	17.3*3.5	16-14AWG(2mm <sup>2</sup> )	Female
10568	401LR	Uninsulated Nylon Bullet Male Connector	Brass Finish	17.8*4.0	16-14AWG(2mm <sup>2</sup> )	Male
4276	402LR	Uninsulated Nylon Bullet Female Connector	Brass Finish	17*3.95	16-14AWG(2mm <sup>2</sup> )	Female

# Uninsulated Male/Female Disconnect

Detailed product specifications are available on: [us.100y.com.tw](http://us.100y.com.tw)



Open barrel terminals (female & male)  
 LR: Loose piece, standard chemical treatment (brass finish)  
 LT: Loose piece, tin plated  
 SR: Strip form, standard chemical treatment (brass finish)  
 ST: Strip form, tin plated  
 Terminal material: brass

ITEM NO.	MATCHING	DIMENSION <sup>Inch</sup> / <sub>mm</sub>			FIGURE
		W	F	L	
501LR	.032x.250 (0.8x6.4)	.248 6.3	.295 7.5	.787 20.0	
503LR		.260 6.6	.295 7.5	.748 19.0	

Part No.	Product No.	Description	Material	Size L*W	Cable No.	Type
7825	501LR	Uninsulated Male Disconnect	Brass Finish	20*6.3	16-14AWG(2mm <sup>2</sup> )	Male
8768	503LR	Uninsulated Female Disconnect	Brass Finish	19*6.6	16-14AWG(2mm <sup>2</sup> )	Female



Open barrel terminals (female & male)  
 LR: Loose piece, standard chemical treatment (brass finish)  
 LT: Loose piece, tin plated  
 SR: Strip form, standard chemical treatment (brass finish)  
 ST: Strip form, tin plated  
 Terminal material: brass

ITEM NO.	MATCHING	DIMENSION <sup>Inch</sup> / <sub>mm</sub>			FIGURE
		W	F	L	
606LR (5)	.020x.110 (0.5x2.8)	.126 3.2	.252 6.4	.630 16.0	
906LR	.020x.110 (0.5x2.8)	.110 2.8	.472 12.0	.827 21.0	

Part No.	Product No.	Description	Material	Size L*W	Cable No.	Type
10566	606LR(5)	Uninsulated Female Disconnect	Brass Finish	16*3.2mm	22-18AWG(1.25mm <sup>2</sup> )	Female
20039	606LT(8)	Uninsulated Female Disconnect	Brass Finish	16*3.2mm	22-18AWG(1.25mm <sup>2</sup> )	Female
10570	906LR	Uninsulated Male Disconnect	Brass Finish	21*2.8mm	22-18AWG(1.25mm <sup>2</sup> )	Male

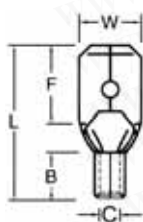

Wire range A. W. G. mm <sup>2</sup>	ITEM NO.	DIMENSION <sup>Inch</sup> / <sub>mm</sub>				
		W	F	L	B	C
16-14A. W. G. 1.5-2.5mm <sup>2</sup>	MDN2-187(5)	0.189 4.8	6.5	15	5.17	2.3

Part No.	Product No.	Description	Material	Size L*W	Cable No.	Type
7952	MDN2-187(5)	Uninsulated Male Disconnect	Copper	14.2*4.8mm	16-14AWG(1.5-2.5mm <sup>2</sup> )	Male

