



Trident Connector Crimp Contacts (Solid Machined)



PLATING

Tin is recommended for most applications. It is cost effective and matches well to most wires. Gold is preferred for special situation. Gold resistance oxidation, has high surface conductivity and has a low coefficient of friction. These feature make good the preferred plating for low level signals (a rule of thumb is <math>I < 100\text{mA}</math>), corrosive environments (for unsealed connectors), and for increased mating cycles. The electrical performance of the contact is determined at the surface of the contact. For this reason, flash gold platings are suitable for applications with 50 or fewer mating cycles thicker gold plating are recommended for more than 50 mating cycles



Part No.	Product No.	Manufacturer	Description	Recive Head/YES
17577	F3806728	ITT	Trident Connector Crimp Contacts	Socket contact

AMP Circular Plastic Connectors

Detailed product specifications are available on: us.100y.com.tw

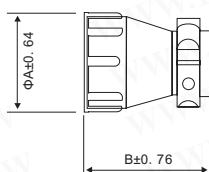

Standard size

Shell size	Abmessungen/Dimensions (mm)	
	A	B
11	21.0	31.8
13	24.5	35.6
17	28.7	35.6
23	40.6	39.5
23	40.6	39.5

Large size

Shell size	Abmessungen/Dimensions (mm)	
	A	B
11	21.0	36.8
13	28.7	42.0
17	28.7	42.0
23	40.6	42.0

AMP

Part No.	Product No.	Manufacturer	Description	Pins
18178	0-0182655-1	AMP	Cable Clamp	16P



AMP

Part No.	Product No.	Manufacturer	Description	Pins	Type
34987	0-0206037-1	AMP	AMP Series 1 CPC Circular Plastic Connectors Receptacle-Square Flanged Receptacle-Free Hanging Plug	16P	Female



SEARCHABLE FEATURES

No. of positions: 4
Gender: receptacle
Used with: pin contacts
Preloaded: No
Terminate to: wire
Shell size: 11
Shell type: all plastic
Shell thread size: 5/8-24UNEF-2A

OTHER PROPERTIES

Wire insulation diameter (mm[in]): 2.54 [0.100]
Panel attachment method: square flange
Housing material: Thermoplastic
Housing color: black
Housing material flammability rating: UL94V-0
Keying: A

AMP

Part No.	Product No.	Manufacturer	Description	Pins	Type
18179	0-0206061-1	AMP	AMP Series 1 CPC Circular Plastic Connectors Receptacle-Square Flanged Receptacle-Free Hanging Plug	4P	SHELL

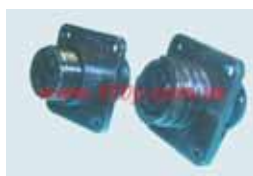

SEARCHABLE FEATURES

No. of positions: 4
Gender: receptacle
Used with: socket contacts
Preloaded: No
Terminate to: wire
Shell size: 11
Shell type: all plastic
Shell thread size: 5/8-24UNEF-2A

OTHER PROPERTIES

Wire insulation diameter (mm[in]): 2.54 [0.100]
Panel attachment method: square flange
Housing material: Thermoplastic
Housing color: black
Housing material flammability rating: UL94V-0
Keying: A

AMP

Part No.	Product No.	Manufacturer	Description	Pins	Type
18189	0-0206430-1	AMP	Receptacle Housing, Reverse Sex, Shell Size 11,CPC	4P	Female



SEARCHABLE FEATURES

Pin/Socket: pin
High current: No
Contact mating area plating: tin
Wire range (mm[AWG]): 0.20-0.56² [24-20]
Insulation diameter (mm[in]): 1.14-1.80 [0.045-0.07]
Contact material: brass

OTHER PROPERTIES

Pin/Cable type: regulator wire
Wire/cable type: regulator wire
Test current (Amps.): 13.0
Spring material: stainless steel
Packing quantity: stainless steel
Grade: commercial

AMP

Part No.	Product No.	Manufacturer	Description	Type
19750	0-163086-1	AMP	AMP Circular Plastic Connectors	Male

