



XS12 Series- Nickle Plated Industrial Circular connectors

Detailed product specifications are available on: us.100y.com.tw



- Rating current: 3A
- Rating voltage: 250V
- Current resistance: $\leq 0.01\Omega$
- Insulating resistance: 2, 3, 4 core is 1500V; 5, 7, 9 core is 1000V

Part No.	Product No.	Description	Shell Size	Pins	M/F Plug/Socket	Rate Current/Voltage
26670	XS12K2P+XS12J2A	X12 Series -Nickle Plated Industrial Circular connector	12mm	2P	Female Plug+Male Socket	3A/250V
27066	XS12K2P+XS12J2Y	X12 Series -Nickle Plated Industrial Circular connector	12mm	2P	Female Plug+Male Socket	3A/250V
27062	XS12K3P+XS12J3A	X12 Series -Nickle Plated Industrial Circular connector	12mm	3P	Female Plug+Male Socket	3A/250V
25684	XS12K3P+XS12J3Y	X12 Series -Nickle Plated Industrial Circular connector	12mm	3P	Female Plug+Male Socket	3A/250V
27063	XS12K4P+XS12J4A	X12 Series -Nickle Plated Industrial Circular connector	12mm	4P	Female Plug+Male Socket	3A/250V
25503	XS12K4P+XS12J4Y	X12 Series -Nickle Plated Industrial Circular connector	12mm	4P	Female Plug+Male Socket	3A/250V
26685	XS12K5P+XS12J5A	X12 Series -Nickle Plated Industrial Circular connector	12mm	5P	Female Plug+Male Socket	3A/250V
33965	XS12K5P+XS12J5Y	X12 Series -Nickle Plated Industrial Circular connector	12mm	5P	Female Plug+Male Socket	3A/250V
27067	XS12K5P+XS12J5Y	X12 Series -Nickle Plated Industrial Circular connector	12mm	5P	Male Plug+Female Socket	3A/250V
39393	XS12K6P+XS12J6A	X12 Series -Nickle Plated	12mm	6P	Female Plug+Male Socket	3A/250V

XSR16 Series- Industrial Circular connectors

Detailed product specifications are available on: us.100y.com.tw

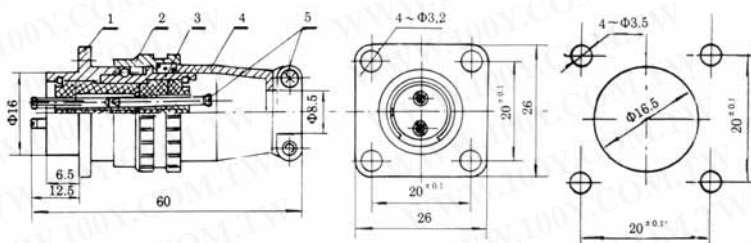

- Rating current: 10A
- Rating voltage: 400V
- Circumstance temperature: $-55^{\circ}\text{C} \sim 85^{\circ}\text{C}$
- Contact resistance: 0.0025Ω
- Insulating resistance: $\geq 1000\text{M}\Omega$



Part No.	Product No.	Description	Shell Size	Pins	M/F Plug/Socket	Rate Current/Voltage
15215	XSR16K2P-XSR16J2A	XSR16 Series -Industrial Circular Connectors	16mm	2P	J: Plug K: Socket	10A/400V

YD Series- Connector

Detailed product specifications are available on: us.100y.com.tw

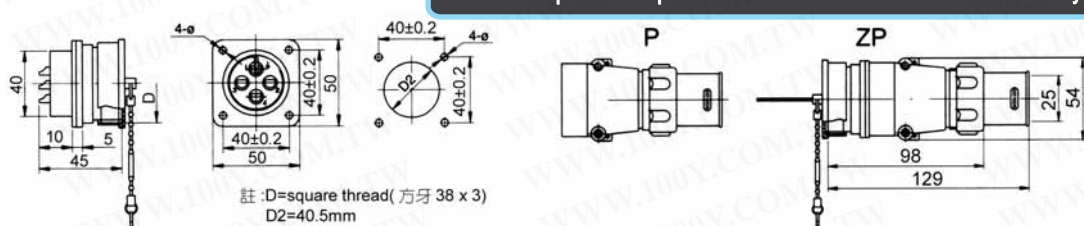

No. of contacts	5	9	26	31		
Contacts Configuration						
Rated current/voltage	—	—	—	—		
Operation limit voltage (AC. V. rms)	—	—	—	—		
Withstanding voltage (AC. V. rms) 1 minute	—	—	—	—		
Insulation resistance (MΩ MIN.) at DC 500V	—	—	—	—		
Contact resistance (MΩ MAX.) at DC 1A	—	—	—	—		
Pin diameter (Φmm)	Φ3. 5x5	Φ2. 5x5 Φ3. 5x4	Φ1. 5x22 Φ2. 5x4	Φ1. 5x31		

Part No.	Product No.	Description	Shell Size	Pins	M/F Plug/Socket	Rate Current/Voltage
16002	YD40J31Z+YD40K31TQ	YD40 Series Connector	40mm	31P	K: Socket T: Plug	10A/500V

