

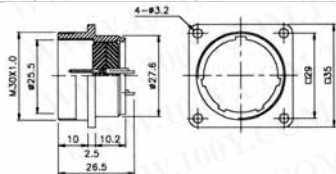

PLS-28 Series- Industrial Circular Connectors & Accessories

Detailed product specifications are available on: us.100y.com.tw

Part No.	Product No.	Manufacturer	Description	M/F Plug/Socket	Rate Current/Voltage	Pins	Shell Size
6292	PLS-2820-ADM	PLT	PLS-28 Series -Industrial Circular Connectors	Male Plug	5A/250V	20P	28mm
6188	PLS-2826-ADM	PLT	PLS-28 Series -Industrial Circular Connectors	Male Plug	5A/250V	26P	28mm



Part No.	Product No.	Manufacturer	Description	M/F Plug/Socket	Rate Current/Voltage	Pins	Shell Size
4836	PLS-2812-RM	PLT	PLS-28 Series -Industrial Circular Connectors	Male Socket	10A/250V	12P	28mm
6277	PLS-2816-RM	PLT	PLS-28 Series -Industrial Circular Connectors	Male Socket	5A/250V	16P	28mm
3193	PLS-2820-RM	PLT	PLS-28 Series -Industrial Circular Connectors	Male Socket	5A/250V	20P	28mm
6236	PLS-2826-RM	PLT	PLS-28 Series -Industrial Circular Connectors	Male Socket	5A/250V	26P	28mm

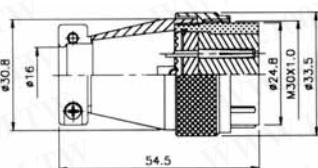

Part No.	Product No.	Manufacturer	Description	M/F Plug/Socket	Rate Current/Voltage	Pins	Shell Size
4829	PLS-2812-PF	PLT	PLS-28 Series -Industrial Circular Connectors	Female Plug	10A/250V	12P	28mm
6289	PLS-2816-PF	PLT	PLS-28 Series -Industrial Circular Connectors	Female Plug	5A/250V	16P	28mm
4832	PLS-2820-PF	PLT	PLS-28 Series -Industrial Circular Connectors	Female Plug	5A/250V	20P	28mm
6154	PLS-2826-PF	PLT	PLS-28 Series -Industrial Circular Connectors	Female Plug	5A/250V	29P	28mm

No. of contacts	7	12	16	17	20	26
Contacts Configuration						
Rated current/voltage	15A 250V	10A 250V	5A 250V	5A 250V	5A 250V	5A 250V
Operation limit voltage (AC. V. rms)	300	250	250	250	250	250
Withstanding voltage (AC. V. rms) 1 minute	1800	1000	1000	1000	1000	1000
Insulation resistance (MΩ MIN.) at DC 500V	1800	1000	1000	1000	1000	1000
Contact resistance (MΩ MAX.) at DC 1A	3	5	5	5	3	3
Pin diameter (Φmm)	2	1.6	1.6	1.6	1.2	1.2

PLS-35 Series- Industrial Circular Connectors & Accessories

Detailed product specifications are available on: us.100y.com.tw

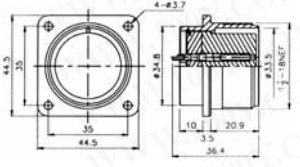
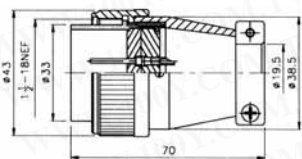

Part No.	Product No.	Manufacturer	Description	Shell Size	Pins	M/F Plug/Socket	Rate Current/Voltage
6172	PLS-3524-PM	PLT	PLS-35 Series -Industrial Circular Connectors	35mm	24P	Male Plug	8A/250V

Part No.	Product No.	Manufacturer	Description	Shell Size	Pins	M/F Plug/Socket	Rate Current/Voltage
8591	PLS-3524-RF	PLT	PLS-35 Series -Industrial Circular Connectors	35mm	24P	Female Plug	8A/250V

No. of contacts	26
Contacts Configuration	
Rated current/voltage	5A 250V
Operation limit voltage (AC. V. rms)	250
Withstanding voltage (AC. V. rms) 1 minute	1000
Insulation resistance (MΩ MIN.) at DC 500V	1000
Contact resistance (MΩ MAX.) at DC 1A	3
Pin diameter (Φmm)	1.2

- We provide a wide range of products to development and maintenance engineers in all type of business
- If you cannot find the components you want on the catalogue, please call us.

Taiwan: 886-3-5753170

Shanghai: 021-54151736

Shenzhen: 0755-83298787

Centenary Materials

Waiting for your phone call



T E L : Taiwan: 886-3-5753170
 F A X : Taiwan: 886-3-5753172
 E-mail : Taiwan: us_sale@100y.com.tw

Shenzhen: 86-755-83298787
 Shenzhen: 86-755-83640655
 Shenzhen: 100y@163.com

Shanghai: 86-21-54151736
 Shanghai: 86-21-64605107
 Shanghai: 100y-1@163.com