



MS3102 Aluminum Alloy Connector Series (water-repellent)

Detailed product specifications are available on: us.100y.com.tw



Cable Strain Relief Clamp

Part No.	Product No.	Description	Shell Size (mm)
22953	MS3057-4A	Cable Strain Relief Clamp	10SL-12-12S

MS3106 Aluminum Alloy Connector Series (water-repellent)

Detailed product specifications are available on: us.100y.com.tw

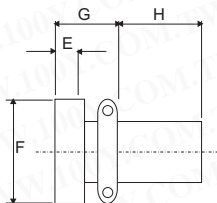

Unit: mm

MIL	SPEC	B	C	E	F	G	H
MS3057-4A	10SL, 12S, 12	7.9	5.6	8	21.4	20.5	60
MS3057-6A	12SL, 14S, 14	11.1	7.9	8	25.4	22.2	55
MS3057-8A	16S, 16	14.3	11.1	8	28.5	23.8	49
MS3057-10A	18	15.9	14.3	8	30.9	23.8	46
MS3057-12A	20, 22	19	15.9	8	35.7	23.8	43
MS3057-16A	24, 28	23.8	15.9	8	42.2	26.1	38
MS3057-20A	32	31.7	19	9.9	52.2	28.1	34
MS3057-24A	36	34.9	23.8	11.2	57.1	29.7	31

Part No.	Product No.	Description	Shell Size (mm)	M/F Plug Socket	Rate Current/Voltage
22963	MS3057-12A	Cable Strain Relief Clamp	20-22	17P	Male
30876	MS3057-16A	Cable Strain Relief Clamp	24-28		
29214	MS3057-6A	Cable Strain Relief Clamp	14-14S		



Resilient inserts resist wear caused by engine vibration
 Durable field proven design meets the latest performance standards of MIL-C-5015
 Price competitive

ELECTRICAL SPECIFICATION

- Insulation resistance: morethen 5000MΩ
- Internal voltage: AC 2000V with stand 1 minute

Part No.	Product No.	Description	Shell Size (mm)	Pins	M/F Plug Socket	Rate Current/Voltage
24415	MS3106A-10SL-3S	3P Female Socket 13A~20A 500Vac	23	3P	Female	13A~20A/500Vac/700Vdc
29215	MS3106A-14S-2S	4P Female Socket 13A~20A 200Vac	28	4P	Female	13A~20A/200Vac/250Vdc
28686	MS3106A-14S-5S	5P Female Socket 13A~20A 200Vac	28	5P	Female	13A~20A/200Vac/250Vdc
29839	MS3106A-14S-6S	6P Female Socket	28	6P	Female	13A~20A/200Vac/250Vdc
33885	MS3106A-14S-7S	3P Female Socket	28	3P	Female	13A~20A/500Vac/700Vdc
35914	MS3106A-16-10S	3P Female Socket 23A~35A 500Vac	31.5	3P	Female	23A~35A/500Vac/700Vdc
37289	MS3106A-16S-1S	7P Female Socket 13A~20A 500Vac	31.5	7P	Female	13A~20A/500Vac/700Vdc
28487	MS3106A-20-16S	9P Female Socket 13A~20A 500Vac	37.3	9	Female	13A~20A/500Vac/700Vdc



DESIGN CHARACTERISTICS

- Medium to heavy weight cylindrical
- Durable field-proven design
- Environmental resistant
- Resilient inserts
- Operating voltage to 3000VAC(RMS) at sea level
- Threaded couplings
- Single key/keyway shell polarization
- Cost effective

Part No.	Product No.	Description	Shell Size (mm)	Pins	M/F Plug Socket	Rate Current/Voltage
33897	MS3106A-10SL-3P	3P Male Socket 13A~20A 500Vac	39.7	3P	Male	13A~20A/500Vac/700Vdc
33898	MS3106A-14A-2P	4P Male Socket	28	4P		13A~20A/200Vac/250Vdc



MS3106A-x(S)-xP



MS3106A-x(S)-xS



MS3106A-24-10S



MS3106B-18-1S
MS3106B-20-15S

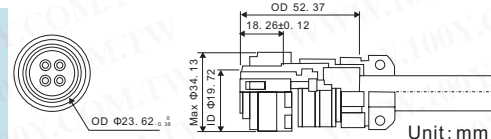

Unit: mm

ELECTRICAL SPECIFICATION

- Insulation resistance: morethen 5000MΩ
- Internal voltage: AC 2000V with stand 1 minute

Part No.	Product No.	Description	Shell Size (mm)	Pins	M/F Plug Socket	Rate Current/Voltage
32186	MS3106A-14S-5P	5P Male Socket 20A 200Vac	28	5P	Male	13A~20A/200Vac/250Vdc
33886	MS3106A-14S-6P	6P Male Socket	28	6P	Male	13A~20A/200Vac/250Vdc
33884	MS3106A-14S-7P	3P Male Socket	28	3P	Male	13A~20A/500Vac/700Vdc
33900	MS3106A-14S-9P	2P Male Socket 13A~20A 500Va	23	2P	Male	13A~20A/21A/500Vac/700Vdc
33901	MS3106A-14S-9S	2P Female Socket 13A~20A 200Vac	23	2P	Female	13A~20A/200Vac/250Vdc
35537	MS3106A-16-10P	3P Male Socket 23A~35A 500Vac	31.5	3P	Male	23A~35A/500Vac/700Vdc

