



MULTIPOLE-CONNECTORS & TOOLS

2.54mm 90° Male Headers (Side Latch)

Detailed product specifications are available on: us.100y.com.tw



FEATURES

- Fully shrouded provides ultimate reliability
- Black or gray insulator available
- Choices of eject level

SPECIFICATION

- Current rate: 1AMP
- Insulation resistance: 5000MΩ Min at DC 500V
- Contact resistance: 20mΩMax. at DC 100mA
- Operation temperature: -55°C~105°C

MATERIAL

- Insulator: PBT G. F
- Contact pinbrass square pin
- Plated: gold plated
- Tin plated

Product No.	A	B	C	D	E
D04-10P	32.00	27.94	10.16	21.84	17.96
D04-14P	37.08	33.02	15.24	26.92	23.04
D04-16P	39.62	35.56	17.78	29.46	25.58
D04-20P	44.70	40.64	22.86	34.54	30.66
D04-24P	49.79	45.72	27.94	39.62	35.74
D04-26P	52.32	48.26	30.48	42.16	38.28
D04-30P	57.40	53.34	35.56	47.24	43.36
D04-34P	62.48	58.42	40.64	52.32	48.44
D04-40P	70.10	66.04	48.26	59.94	56.06
D04-50P	82.80	78.74	60.96	72.64	68.76
D04-64P	100.58	96.52	78.74	90.42	86.54

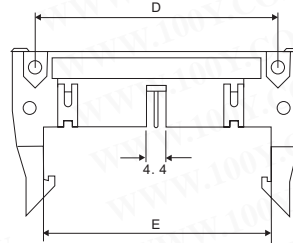
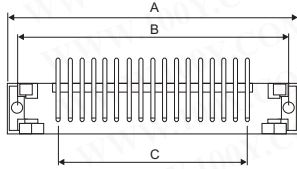

Unit: mm



Part No.	Product No.	Manufacturer	Description	Contacts
4182	310-14		2.54mm 90° Male Headers (Side Latch)	14P
2327	310-20		2.54mm 90° Male Headers (Side Latch)	20P
4174	310-24P		2.54mm 90° Male Headers (Side Latch)	24P
8787	310-26		2.54mm 90° Male Headers (Side Latch)	26P
4175	310-30		2.54mm 90° Male Headers (Side Latch)	30P
4176	310-34		2.54mm 90° Male Headers (Side Latch)	34P
3822	310-40		2.54mm 90° Male Headers (Side Latch)	40P
2921	310-50		2.54mm 90° Male Headers (Side Latch)	50P
23508	310-60		2.54mm 90° Male Headers (Side Latch)	60P
4177	310-64		2.54mm 90° Male Headers (Side Latch)	64P
16993	3764-5302	3M	2.54mm 90° Male Headers (Side Latch)	64P
4172	D04-10P		2.54mm 90° Male Headers (Side Latch)	10P
4173	D04-16P		2.54mm 90° Male Headers (Side Latch)	16P

2.54mm IDC Socket Connectors

Detailed product specifications are available on: us.100y.com.tw



ELECTRICAL CHARACTERISTICS

- Current rating: 1Amp
- Insulation resistance: 5000MΩ min at DC 500V
- Contact resistance: 20mΩ max. at DC 100mA
- Operating temperature: -55°C~+105°C

FEATURES

- Optional polarizing key, polarizing bump
- Optional strain relief
- Choice of gold plated or selective gold plated

MATERIAL

- Housing: 30% glass filled PBT UL94V-0
- Contact: phosphor bronze
- Plating: selective gold plated: gold plated on mating area and nickel plated on wire cutting area
- Gold plated: 3u" over 50u" nickel
- Cable: 0.635mm (0.025) pitch flat cable

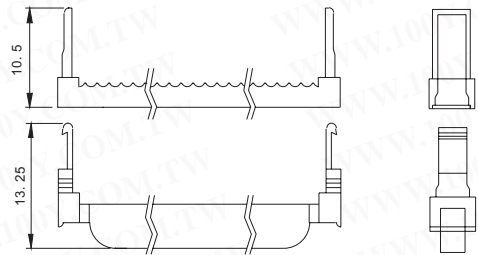
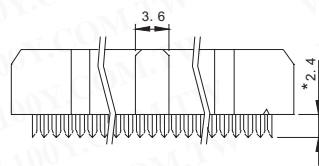
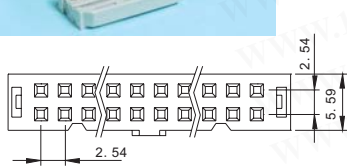

Unit: mm

Part No.	Product No.	Description	Contacts
10085	280-64	2.54mm IDC Socket Connectors	64P
26888	D01-08P	2.54mm IDC Socket Connectors (8Pins Tin-Plated)	8P
30388	D01-14P	2.54mm IDC Socket Connectors (14Pins Tin-Plated)	14P
4192	D01-16P	2.54mm IDC Socket Connectors	16P
19742	D01-18P	2.54mm IDC Socket Connectors	18P
2923	IDCB0-210101B01	2.54mm IDC Socket Connectors	10P
4194	IDCB0-214101B01	2.54mm IDC Socket Connectors	14P
2920	IDCB0-220101B01	2.54mm IDC Socket Connectors	20P
4193	IDCB0-224101B01	2.54mm IDC Socket Connectors	24P
4195	IDCB0-230101B01	2.54mm IDC Socket Connectors	30P
4189	IDCB0-234102B01	2.54mm IDC Socket Connectors	34P
4190	IDCB0-240102B01-G	2.54mm IDC Socket Connectors	40P
4196	IDCB0-250102B01	2.54mm IDC Socket Connectors	50P
8008	IDCB0-260101B01	2.54mm IDC Socket Connectors	60P
3259	IDCB0-2261TTB01	2.54mm IDC Socket Connectors	26P



T E L : Taiwan: 886-3-5753170
 F A X : Taiwan: 886-3-5753172
 E-mail : Taiwan: us_sale@100y.com.tw

Shenzhen: 86-755-83298787
 Shenzhen: 86-755-83640655
 Shenzhen: 100y@163.com

Shanghai: 86-21-54151736
 Shanghai: 86-21-64605107
 Shanghai: 100y-1@163.com