

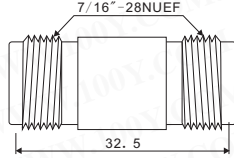

# RF/COAXIAL-CONNECTORS & TOOLS

## TNC Coax T & Straight Adapters

Detailed product specifications are available on: [us.100y.com.tw](http://us.100y.com.tw)



TNC Double Female

Part No.	Product No.	Description
3278	MCI-7433	TNC Double Female

## SMA Serie Connectors Nickel Plated- SMA Crimp Plugs and Jacks

Detailed product specifications are available on: [us.100y.com.tw](http://us.100y.com.tw)

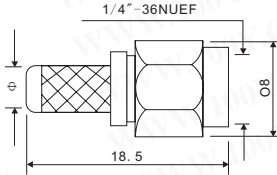
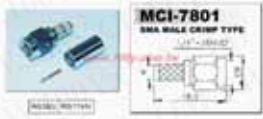

SMA male crimp type

Part No.	Product No.	Description	Cable Types
3282	MCI-7801A-RG58U	SMA Male Crimp Type	RG58/U
2401	MCI-7801B-RG174U	SMA Male Crimp Type	RG174/U



Right Angle SMB Male P.CB Mount

Part No.	Product No.	Description
28528	MCI-9111	Right Angle SMB Male P.CB Mount

## Nickel Plated-PCB Mounting SMA Sockets

Detailed product specifications are available on: [us.100y.com.tw](http://us.100y.com.tw)

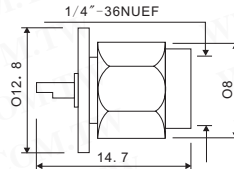

SMA male chassis mount

Part No.	Product No.	Description
3284	MCI-7807	SMA Male Chassis Mount

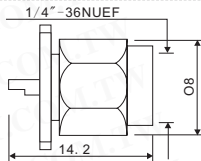

SMA male chassis mount

Part No.	Product No.	Description
3286	MCI-7808	SMA M Chassis Mount

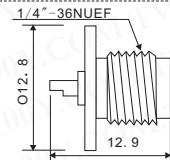

SMA female chassis mount

Part No.	Product No.	Description
3285	MCI-7814	SMA F Chassis Mount

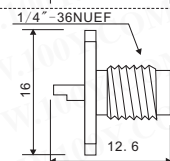

SMA female chassis mount

Part No.	Product No.	Description
2898	MCI-7815	SMA Female Chassis Mount

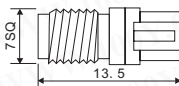

SMA female P. C board mount

Part No.	Product No.	Description
17500	MCI-7845	SMA FEMALE P.C BOARD MOUNT

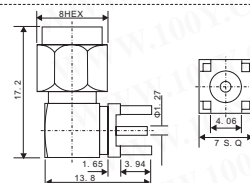

SMA plug PCB mount right angle

Part No.	Product No.	Description
33549	SMA3400-9000	JYEBAO_SMA (M)RA JACK PCB MOUNT

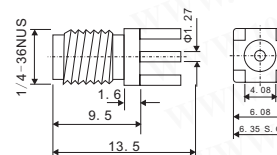

SMA jack PCB mount

Part No.	Product No.	Manufacturer	Description
20584	SMA8400-0000	JYEBAO	JYEBAO_SMA JACK PCB MOUNT

